

**NOTICE!!**

**These documents have been scanned!**

**Do not place un-scanned documents beneath this notice!**

**Do not remove this notice from this file!**

GPO Jacket No. 560-102  
Print Order 61540  
Rise Business Services, LLC  
Job=AZ15 4/26/2019



Box Number= AZ15002



Claim Begin-End: AMC450029-AMC450038

1 Initial Receipt



AZ15002-18

AMC450400-AMC453366



**United States Department of the Interior**  
**Bureau of Land Management**  
 DIV OF LANDS, MINRLS & ENERGY  
 ONE N CENTRAL AVE  
 PHOENIX, AZ 85004 -4427  
 Phone: 602-417-9200

Receipt

No:

4114006

<b>Transaction #:</b> 4227334	
<b>Date of Transaction:</b> 03/16/2018	
<b>CUSTOMER:</b>	
	RANDY SEALEY 1127 VICTORY AVE BILLINGS, MT 59105-1856 US

**ENTERED**  
**MAR 22 2018**  
 BY: *RSM*

LINE #	QTY	DESCRIPTION	REMARKS	UNIT PRICE	TOTAL
1	10.00	LOCATABLE MINERALS / MINING CLAIMS-NEW, UNADJUD, ONE OR MORE AUTH NOS / NEW MINING CLAIM PROCESSING FEE <b>CASES:</b> AMC450029/\$20.00, AMC450030/\$20.00, AMC450031/\$20.00, AMC450032/\$20.00, AMC450033/\$20.00, AMC450034/\$20.00, AMC450035/\$20.00, AMC450036/\$20.00, AMC450037/\$20.00, AMC450038/\$20.00		- n/a -	200.00
2	10.00	LOCATABLE MINERALS / MINING CLAIMS-NEW, UNADJUD, ONE OR MORE AUTH NOS / NEW MINING CLAIMS LOCATION FEE <b>CASES:</b> AMC450029/\$37.00, AMC450030/\$37.00, AMC450031/\$37.00, AMC450032/\$37.00, AMC450033/\$37.00, AMC450034/\$37.00, AMC450035/\$37.00, AMC450036/\$37.00, AMC450037/\$37.00, AMC450038/\$37.00		- n/a -	370.00
3	10.00	LOCATABLE MINERALS / MINING CLAIMS-NEW, UNADJUD, ONE OR MORE AUTH NOS / NEW MINING CLAIMS MAINTENANCE FEE <b>CASES:</b> AMC450029/\$155.00, AMC450030/\$155.00, AMC450031/\$155.00, AMC450032/\$155.00, AMC450033/\$155.00, AMC450034/\$155.00, AMC450035/\$155.00, AMC450036/\$155.00, AMC450037/\$155.00, AMC450038/\$155.00		- n/a -	1550.00
4	1.00	LOCATABLE MINERALS / MINING CLAIMS-NOT NEW-UNADJUD, ONE AUTH NO. ONLY / MINING CLAIM MONEY RECEIVED <b>CASES:</b> AMC450029/\$775.00	ADDITIONAL PLACER FEES	- n/a -	775.00

**TOTAL: \$2,895.00**

## PAYMENT INFORMATION

1	AMOUNT:	2895.00	POSTMARKED:	N/A
	TYPE:	CHECK	RECEIVED:	03/16/2018
	CHECK NO:	35574		
	NAME:	WESTERN SUN EXPLORATION INC 1127 VICTORY AVE BILLINGS MT 59105-1856 US		

## REMARKS

This receipt was generated by the automated BLM Collections and Billing System and is a paper representation of a portion of the official electronic record contained therein.



**NOTICE!!**

**These documents have been scanned!**

**Do not place un-scanned documents beneath this notice!**

**Do not remove this notice from this file!**

GPO Jacket No. 560-102  
Print Order 61540  
Rise Business Services, LLC  
Job=AZ15 4/26/2019



Box Number= AZ15002



Claim Begin-End: AMC450029-AMC450038

2 Correspondence



AZ15002-18

AMC450400-AMC453366





# United States Department of the Interior

## BUREAU OF LAND MANAGEMENT

Arizona State Office

One North Central Avenue, Suite 800

Phoenix, Arizona 85004-4427

[www.blm.gov/az/](http://www.blm.gov/az/)

AUG 17 2018



In Reply Refer To:

3800 (9200) RM

AMC450029

CERTIFIED MAIL - RETURN RECEIPT REQUESTED No. 9214 8901 9403 8308 9492 70

### NOTICE

RANDY L SEALEY AND TRISH EDWARDS  
1127 VICTORY AVE  
BILLINGS, MT 59105-1856

: This Notice Affects the Claims  
: Shown in the Block Below.  
:

---

AMC450036, AMC450037

SAN #35-2, SAN #35-3

---

### Mining Claim Location Notice(s) – Amendment(s) Required

Pursuant to Title 43 Code of Federal Regulations (CFR) 3832.1, the Bureau of Land Management (BLM), Arizona State Office, received your notices of location for recording mining claims. In accordance with 43 CFR 3832.12, the claims listed above cannot be accepted as filed and must be amended as noted below.

- AMC450036 – The location notice states the claim is in T. 7 N., R. 4 W., sec. 35 NE1/4SW1/4. The map depicts the claim in T. 7 N., R. 4 W., sec. 35 SE1/4SW1/4.
- AMC450037 – The location notice states the claim is in T. 7 N., R. 4 W., sec. 35 SE1/4SW1/4. The map depicts the claim in T. 7 N., R. 4 W., sec. 35 NE1/4SW1/4.
- It appears that the map page for San #35-2 was submitted with the first page of the location notice for San #35-3 and the map page for San #35-3 with the first page of the location notice for San #35-2.

An amendment must be filed for each claim listed above to correct the defects identified. There is a \$10 BLM processing fee for each amendment. The amendments must be received by BLM within 30-days of your receipt of this notice. If the amendments are not received within the 30-day timeframe the mining claims will be declared null and void.

If additional information is required, please contact RéAnn Myers at 602-417-9413. Please include your AMC serial number(s) on all correspondence.

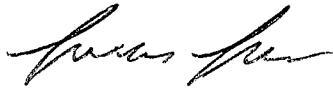

Lucas Lucero  
Deputy State Director  
Lands, Minerals and Energy Division

Enclosure(s)





Date Produced: 08/28/2018

ConnectSuite Inc.:

The following is the delivery information for Certified Mail™/RRE item number 9214 8901 9403 8308 9492 70. Our records indicate that this item was delivered on 08/24/2018 at 09:05 a.m. in BILLINGS, MT 59105. The scanned image of the recipient information is provided below.

Signature of Recipient :

Patricia Edwards

A handwritten signature in black ink, appearing to read "Patricia Edwards", with a stylized flourish at the end.

Address of Recipient :

1127 Victory Ave

Thank you for selecting the Postal Service for your mailing needs. If you require additional assistance, please contact your local post office or Postal Service representative.

Sincerely,  
United States Postal Service

The customer reference number shown below is not validated or endorsed by the United States Postal Service. It is solely for customer use.

Customer Reference Number: C948242.5519935

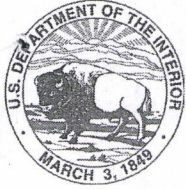

# United States Department of the Interior

BUREAU OF LAND MANAGEMENT

Arizona State Office

One North Central Avenue, Suite 800

Phoenix, Arizona 85004-4427

[www.blm.gov/az/](http://www.blm.gov/az/)

AUG 17 2018



In Reply Refer To:

3800 (9200) RM

AMC450029

CERTIFIED MAIL - RETURN RECEIPT REQUESTED No. 9214 8901 9403 8308 9492 01

## DECISION

RANDY L SEALEY AND TRISH EDWARDS	:	This Decision Affects Those Claims
1127 VICTORY AVE	:	Shown in the Block Below.
BILLINGS, MT 59105-1856	:	

---

AMC450029 - AMC450033

SAN #2-1, SAN #2-2, SAN #2-3, SAN #2-4, SAN #2-5

---

### Mining Claim(s) Declared Null and Void

Pursuant to Title 43 Code of Federal Regulations (CFR) 3832.1, this office received your notice(s) of location for recording mining claims. In accordance with 43 CFR 3833.91, the claim(s) listed above is/are hereby declared null and void ab initio for the reason indicated below. A copy of the Master Title Plat is enclosed for your convenience, if applicable.

The claims are located on land that is not open to location. The surface was reconveyed to the U.S. by AZPHX 081024, dated September 11, 1950, but the subsurface was retained by the grantor.

This decision does not relieve you of the liability for reclamation of all areas disturbed by your activities on land encompassed by your mining claim(s) and/or site(s). After you complete the reclamation, you must notify the authorized officer of the appropriate surface managing agency so that the authorized officer may conduct a final site inspection and determine whether you may be released from liability. If you fail to reclaim the land to the satisfaction of the authorized officer, the surface management agency may cite you for noncompliance under its surface management regulations.

For land administered by the Bureau of Land Management (BLM), if you fail to reclaim the land to the satisfaction of the authorized officer as required in 43 CFR Subpart 3809, the BLM will issue an order of noncompliance under 43 CFR 3809.601(a). If you fail to comply with the noncompliance order, the BLM may take further action under 43 CFR 3809.604. Failure to conduct reclamation is a prohibited act that may subject you to criminal penalties. See 43 CFR 3809.605(h) and 43 CFR 3809.700. If your occupancy has been terminated and you fail to remove structures, material, and equipment, and any personal property in accordance with the regulations in 43 CFR 3715.5-1, the BLM may dispose of the property. In accordance with 43 CFR 3715.5-2, you will remain liable for the costs the BLM incurs in removing and disposing of the property.



### Appeal Procedures

This decision may be appealed to the Interior Board of Land Appeals, Office of the Secretary, in accordance with the regulations contained in 43 CFR, Part 4 and the enclosed Form 1842-1. If an appeal is taken, your notice of appeal must be filed in this office (at the above address) within 30 days from receipt of this decision. The appellant has the burden of showing that the decision appealed from is in error.

If you wish to file a petition pursuant to regulation 43 CFR 4.21 (58 FR 4939, January 19, 1993), for a stay of the effectiveness of this decision during the time that your appeal is being reviewed by the Board, the petition for a stay must accompany your notice of appeal. A petition for a stay is required to show sufficient justification based on the standards listed below. Copies of the notice of appeal and petition for a stay must also be submitted to each party named in this decision and to the Interior Board of Land Appeals and to the appropriate Office of the Solicitor (see 43 CFR 4.413) at the same time the original documents are filed with this office. If you request a stay, you have the burden of proof to demonstrate that a stay should be granted.

### Standards for Obtaining a Stay

Except as otherwise provided by law or other pertinent regulation, a petition for a stay of a decision pending appeal shall show sufficient justification based on the following standards:

- (1) The relative harm to the parties if the stay is granted or denied,
- (2) The likelihood of the appellant's success on the merits,
- (3) The likelihood of immediate and irreparable harm if the stay is not granted, and
- (4) Whether the public interest favors granting the stay.

If additional information is required, please contact RéAnn Myers at 602-417-9413. Please include your AMC serial number(s) on all correspondence.

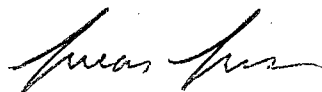

Lucas Lucero  
Deputy State Director  
Lands, Minerals and Energy Division

Enclosure(s)



Date Produced: 09/03/2018

ConnectSuite Inc.:

The following is the delivery information for Certified Mail™/RRE item number 9214 8901 9403 8308 9492 01. Our records indicate that this item was delivered on 08/28/2018 at 01:15 p.m. in BILLINGS, MT 59105. The scanned image of the recipient information is provided below.

Signature of Recipient :

A handwritten signature in black ink, appearing to be "J. J. [unclear]", written over a horizontal line.

Address of Recipient :

A handwritten address in black ink, appearing to be "11 [unclear]", written over a horizontal line.

Thank you for selecting the Postal Service for your mailing needs. If you require additional assistance, please contact your local post office or Postal Service representative.

Sincerely,  
United States Postal Service

The customer reference number shown below is not validated or endorsed by the United States Postal Service. It is solely for customer use.

Customer Reference Number: C948242.5519928



[The body of the document contains extremely faint, illegible text that appears to be a series of lines or paragraphs. Due to the low contrast and quality of the scan, the specific content cannot be transcribed.]

**NOTICE!!**

**These documents have been scanned!**

**Do not place un-scanned documents beneath this notice!**

**Do not remove this notice from this file!**

GPO Jacket No. 560-102  
Print Order 61540  
Rise Business Services, LLC  
Job=AZ15 4/26/2019



Box Number= AZ15002



Claim Begin-End: AMC450029-AMC450038

3 Transfers



AZ15002-18

AMC450400-AMC453366

**NO  
DOCUMENTS  
FOUND**

NO DOCUMENTS FOUND  
NO DOCUMENTS FOUND



**NOTICE!!**

**These documents have been scanned!**

**Do not place un-scanned documents beneath this notice!**

**Do not remove this notice from this file!**

GPO Jacket No. 560-102  
Print Order 61540  
Rise Business Services, LLC  
Job=AZ15 4/26/2019



Box Number= AZ15002



Claim Begin-End: AMC450029-AMC450038

4 Annual Filings



AZ15002-18

AMC450400-AMC453366



DEPARTMENT OF THE INTERIOR  
BUREAU OF LAND MANAGEMENT  
MINING CLAIMS

Run Date/Time: 9/11/2018

MC Maintenance Fees Paid Through the BLM Pay Portal  
(by Date Paid)

Page 514 Of 723

**CBS Receipt: 4250947**

Agency Tracking ID: 1535643135

Assessment Year: 2019

Paid On: 8/30/2018

Printed For Lead File # AMC450029

Number of BLM Serial Nr: 17

Total Amount Paid: \$3,410.00

Claim Name	BLM Serial No	Lead File No	Amount Paid
WESTERN SUN 1	AMC396407	AMC396401	\$155.00
WESTERN SUN 2	AMC396408	AMC396401	\$155.00
WESTERN SUN 3	AMC396409	AMC396401	\$155.00
ROGERS 27-1	AMC449112	AMC449112	\$155.00
ROGERS 27-2	AMC449113	AMC449112	\$155.00
ROGERS 27-3	AMC449114	AMC449112	\$155.00
ROGERS 27-4	AMC449115	AMC449112	\$155.00
ROGERS 27-5	AMC449118	AMC449117	\$155.00
ROGERS 27-6	AMC449119	AMC449117	\$155.00
ROGERS 33-1	AMC449120	AMC449117	\$310.00
ROGERS 34-1	AMC449121	AMC449117	\$155.00
ROGERS 34-2	AMC449122	AMC449117	\$155.00
SAN #35-0	AMC450034	AMC450029	\$310.00
SAN #35-1	AMC450035	AMC450029	\$310.00
SAN #35-2	AMC450036	AMC450029	\$310.00
SAN 35-3	AMC450037	AMC450029	\$310.00
SAN 35-4	AMC450038	AMC450029	\$155.00

**United States Department of the Interior**

**Bureau of Land Management**

BUSINESS & SUPPORT SVCS DIV

ONE N CENTRAL AVE SUITE 800

PHOENIX, AZ 85004 -4427

Phone: 602-417-9200

Receipt

No:

4250947

<b>Transaction #:</b> 4366455	
<b>Date of Transaction:</b> 08/30/2018	
<b>CUSTOMER:</b>	
	RANDY SEALEY 1127 VICTORY AVE BILLINGS, MT 59105 US

LINE #	QTY	DESCRIPTION	REMARKS	UNIT PRICE	TOTAL
1	1.00	LOCATABLE MINERALS / MINING CLAIMS- NOT NEW-UNADJUD, ONE AUTH NO. ONLY / MINING CLAIM MONEY RECEIVED CASES: AMC396407/\$3410.00		- n/a -	3410.00
<b>TOTAL:</b>					<b>\$3,410.00</b>

PAYMENT INFORMATION				
NOTE: Items will appear on credit card statement as "BLM O Mining Claim".				
1	AMOUNT:	3410.00	POSTMARKED:	N/A
	TYPE:	CREDIT CARD	RECEIVED:	08/30/2018
	NAME:	RANDY SEALEY 1127 VICTORY AVE BILLINGS MT 59105 US		
	CARD NO:	XXXXXXXXXXXX5200	AUTH CODE:	08646A
	NAME ON CARD:	RANDY SEALEY		
	SIGNATURE:			

REMARKS

This receipt was generated by the automated BLM Collections and Billing System and is a paper representation of a portion of the official electronic record contained therein.



**NOTICE!!**

**These documents have been scanned!**

**Do not place un-scanned documents beneath this notice!**

**Do not remove this notice from this file!**

GPO Jacket No. 560-102  
Print Order 61540  
Rise Business Services, LLC  
Job=AZ15 4/26/2019



Box Number= AZ15002



Claim Begin-End: AMC450029-AMC450038

5 Miscellaneous



AZ15002-18

AMC450400-AMC453366

## United States Department of the Interior

## Bureau of Land Management

DIV OF LANDS, MINRLS &amp; ENERGY

ONE N CENTRAL AVE

PHOENIX, AZ 85004 -4427

Phone: 602-417-9200

Receipt

No:

4264451

Transaction #: 4380108

Date of Transaction: 09/17/2018

## CUSTOMER:

RANDY SEALEY  
1127 VICTORY AVE  
BILLINGS, MT 59105-1856 US

LINE #	QTY	DESCRIPTION	REMARKS	UNIT PRICE	TOTAL
1	1.00	LOCATABLE MINERALS / MINING CLAIMS- NOT NEW-UNADJUD, ONE AUTH NO. ONLY / MINING CLAIM MONEY RECEIVED CASES: AMC450036/\$20.00	AMEND/2	- n/a -	20.00
TOTAL:					\$20.00

PAYMENT INFORMATION			
1	AMOUNT:	20.00	POSTMARKED: N/A
	TYPE:	CHECK	RECEIVED: 09/14/2018
	CHECK NO:	3154	
	NAME:	GOLDROCK MINERALS LLC 1127 VICTORY AVE BILLINGS MT 59105-1856 US	

## REMARKS

This receipt was generated by the automated BLM Collections and Billing System and is a paper representation of a portion of the official electronic record contained therein.

9/21/2018 635 ENTERED ON AMC 450036  
AND 450037 FOR AMENDMENTS  
DET LTR DTD 8/17/2018. RM



# United States Department of the Interior

BUREAU OF LAND MANAGEMENT

Arizona State Office

One North Central Avenue, Suite 800

Phoenix, Arizona 85004-4427

[www.blm.gov/az/](http://www.blm.gov/az/)

AUG 17 2010



PHOENIX, ARIZONA

2010 SEP 14 P 2:10

RECEIVED  
BLM AZ STATE OFFICE

In Reply Refer To:  
3800 (9200) RM  
AMC450029

CERTIFIED MAIL - RETURN RECEIPT REQUESTED No. 9214 8901 9403 8308 9492 70

## NOTICE

RANDY L SEALEY AND TRISH EDWARDS  
1127 VICTORY AVE  
BILLINGS, MT 59105-1856

: This Notice Affects the Claims  
: Shown in the Block Below.  
:

---

AMC450036, AMC450037  
SAN #35-2, SAN #35-3

---

### Mining Claim Location Notice(s) – Amendment(s) Required

Pursuant to Title 43 Code of Federal Regulations (CFR) 3832.1, the Bureau of Land Management (BLM), Arizona State Office, received your notices of location for recording mining claims. In accordance with 43 CFR 3832.12, the claims listed above cannot be accepted as filed and must be amended as noted below.

- AMC450036 – The location notice states the claim is in T. 7 N., R. 4 W., sec. 35 NE1/4SW1/4. The map depicts the claim in T. 7 N., R. 4 W., sec. 35 SE1/4SW1/4.
- AMC450037 – The location notice states the claim is in T. 7 N., R. 4 W., sec. 35 SE1/4SW1/4. The map depicts the claim in T. 7 N., R. 4 W., sec. 35 NE1/4SW1/4.
- It appears that the map page for San #35-2 was submitted with the first page of the location notice for San #35-3 and the map page for San #35-3 with the first page of the location notice for San #35-2.

An amendment must be filed for each claim listed above to correct the defects identified. There is a \$10 BLM processing fee for each amendment. The amendments must be received by BLM within 30-days of your receipt of this notice. If the amendments are not received within the 30-day timeframe the mining claims will be declared null and void.



If additional information is required, please contact RéAnn Myers at 602-417-9413. Please include your AMC serial number(s) on all correspondence.

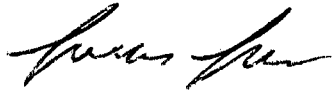

Lucas Lucero  
Deputy State Director  
Lands, Minerals and Energy Division

Enclosure(s)

RECEIVED  
BLM AZ STATE OFFICE  
2010 SEP 14 P 2:10  
PHOENIX, ARIZONA

Goldrock Minerals  
1127 Victory Ave  
Billings, MT 59105

CERTIFIED MAIL®

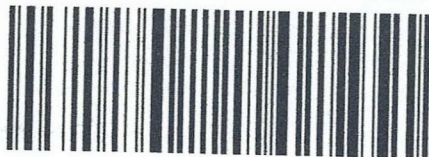

2018 0680 0001 2692 0099



1000

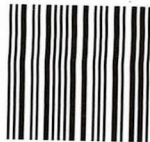

85004

U.S. POSTAGE PAID  
FCM LETTER  
BILLINGS, MT  
59105  
SEP 11, 18  
AMOUNT

**\$6.41**

R2304M110483-06



RECEIVED  
BILLINGSLAND OFFICE  
1208 SEP 14 P 2:09  
PHOENIX, ARIZONA

BLM

1 North Central Ave Suite # 800

Phoenix, AZ 85004-4427

RETURN RECEIPT  
REQUESTED

85004\$4427 CO41

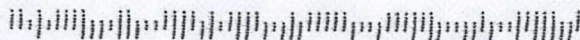

**NOTICE!!**

**These documents have been scanned!**

**Do not place un-scanned documents beneath this notice!**

**Do not remove this notice from this file!**

GPO Jacket No. 560-102  
Print Order 61540  
Rise Business Services, LLC  
Job=AZ15 4/26/2019



Box Number= AZ15002



Claim Begin-End: AMC450029-AMC450038

6 Location Notices-Amendments and Supporting Documents



AZ15002-18

AMC450400-AMC453366



# MINING CLAIM STATUS REPORT

Data Entered: 3/22/18

MTP Checked By: printed

GEO Checked By: printed

LEAD SERIAL NUMBER: AMC 450029 thru AMC 450038 not checked

## NUMBER OF CLAIMS & TYPE:

LODE  
10 PLACER  
 ASSOCIATION PLACER  
 MILL SITE  
 TUNNEL SITE

## CHARGES:

Processing Fee @ \$20 = \$ 200  
 Location Fee @ \$37 = \$ 370  
 Maintenance Fee @ \$155 = \$ 1550  
 Add'l Maint Fee for Assoc Placer = \$ 775  
**SUBTOTAL** \$

TOTAL ACREAGE: \_\_\_\_\_ Per Claim  
 (Placer Only)

Other Fees \$  
 Other Fees \$

NUMBER OF LOCATORS: \_\_\_\_\_

**TOTAL** \$ 2,895

DOCUMENTS RECEIVED VIA: Over-the-Counter ☒ Mail ☐ TIMELY FILED: Yes ☒ No ☐

LEGAL DESCRIPTION: T 6N R 4W SEC 2  
 T 7N R 4W SEC 35  
 T \_\_\_\_\_ R \_\_\_\_\_ SEC \_\_\_\_\_  
 T \_\_\_\_\_ R \_\_\_\_\_ SEC \_\_\_\_\_  
 T \_\_\_\_\_ R \_\_\_\_\_ SEC \_\_\_\_\_

BLM ☐ FOREST SERVICE ☐ SUBJ TO PL 359: Yes ☐ No ☐  
 WILDERNESS AREA ☐

SPLIT ESTATE: N/A ☐ SX ☐ PX ☐ OTHER ☐  
 SRHA ☐ Was proper Notice filed if located on SHRA Land? Yes ☐ No ☐

## RECONVEYED MINERALS ON BLM LAND REQUIRE OPENING ORDER FROM 1944 TO 1993:

Open to Entry On \_\_\_\_\_ N/A ☐

COMMENTS/STATUS: VOID ☐ PARTIALLY VOID ☐ PVT MINERALS ☐ WITHDRAWN LANDS ☐  
 OTHER ☐

\* no status checked -

[ ] Claimant acknowledges that portions of the following claim(s) site(s) may be void or voidable.

Printed Name of Claimant \_\_\_\_\_ Signature of Claimant \_\_\_\_\_

\*\*\*\*\*FINAL ADJUDICATION\*\*\*\*\*

DATE 8/9/2018 INITIALS PM

AMC450029

**LOCATION NOTICE FOR PLACER MINING CLAIM**

NOTICE IS HEREBY GIVEN that the

The "San #2-1" placer mining claim has been located

by Randy Sealey & Trish Edwards, whose current mailing address is

1127 Victory Ave.,

Billings, Mt. 59105

BLM

Date

Stamp

PHOENIX, ARIZONA

2018 MAR 16 P 12:17

RECEIVED  
BLM AZ STATE OFFICE

The general course of this claim is North-South and it is situated in Maricopa County, Arizona. This claim is 1,320 feet in length and 1,320 feet in width. This claim runs from the location monument on which this location notice is posted approximately 1,320 feet in a W direction to the SW corner and 1,320 feet in a N direction to the NW corner.

Four monuments mark this claim, one at each corner.

The location monument on which this notice is posted is situated within Section 2, Township 6 North, Range 4 West, Gila Salt River Base and Meridian, Arizona and this claim encompasses portions of the following quarter section (s), section (s), Township (s) and Range (s) W ½ NW ¼ NE ¼, E ½ NE ¼ NW ¼ of Section 2, T6N, R4W Gila Salt River Base and Meridian, Arizona. The locality of this claim with reference to some natural object or permanent monument and additional information (If any) concerning its locality are as follows: This claim is located approximately 2 miles SW of San Domingo Peak & approximately 4,100' NW of the US Survey Marker located on the SE corner of Section 2 with the wash running NE to SW through the claim.

DATED AND POSTED on the ground this 14<sup>th</sup> day of March, 2018.

LOCATORS: Trish Edwards & Randy Sealey

Signatures

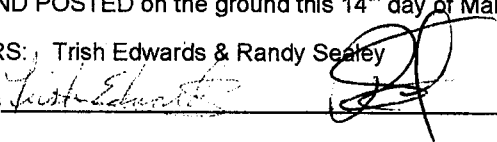

AHC450029

Form MCFIOO  
Revised July 2005

RECEIVED  
BLM AZ STATE OFFICE  
2018 MAR 16 P 8:17  
PHOENIX, ARIZONA

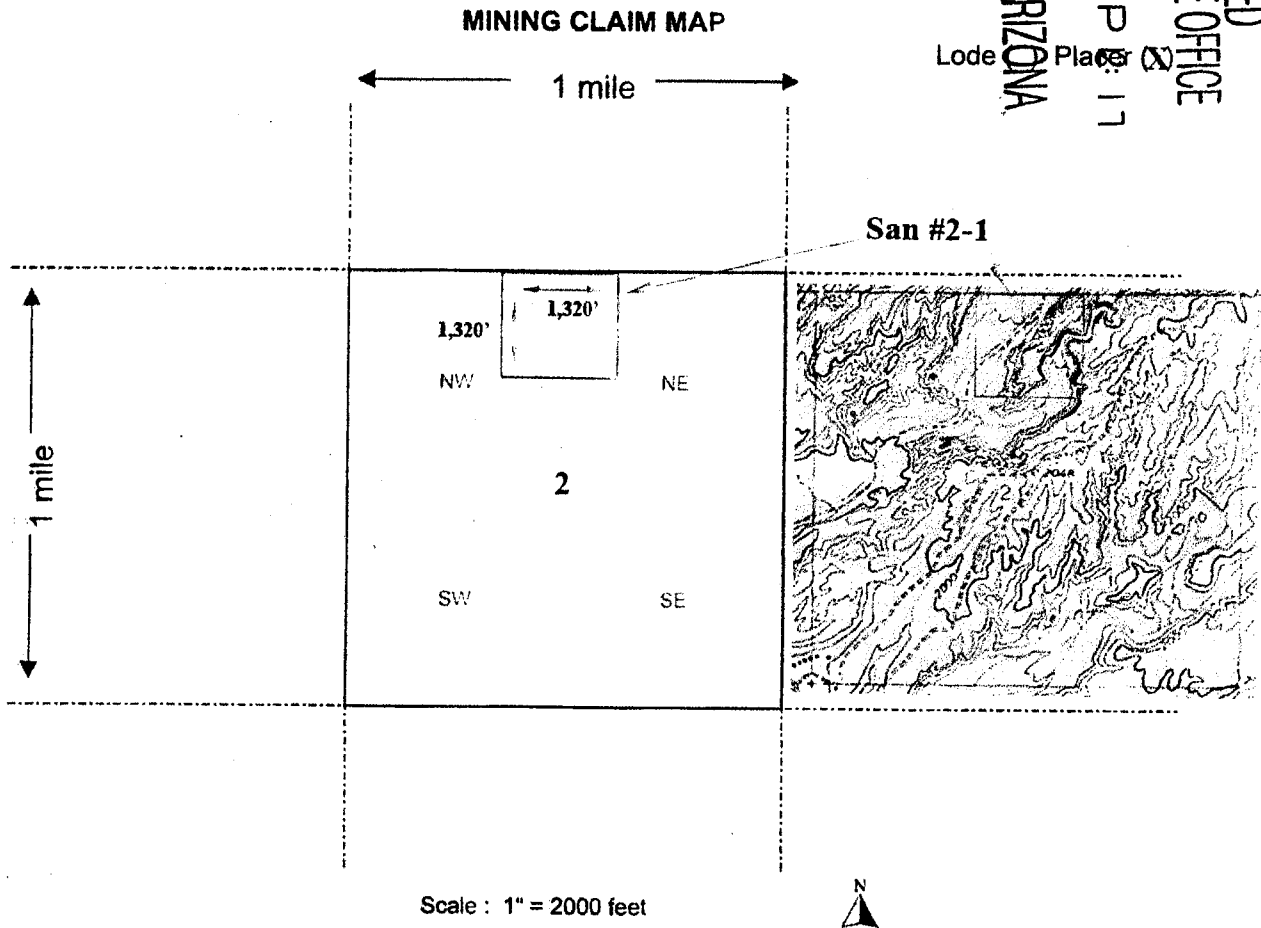

1. The above map depicts the San #2-1 mining claim, which is located in Section (s) 2, Township 6 N, Range 4 W, Gila and Salt River Base and Meridian, Maricopa County, Arizona.
2. The type of corner and location monuments used are as follows: 1 1/2" Poly Pipe, 4 feet long/ cap
3. The bearings and distances in degrees and feet between claim corners are as depicted on the map.

Form MCF100a  
Revised July 2005

This form is available from the Arizona Department of Mines & Mineral Resources and may be reproduced.

AHC450029



**LOCATION NOTICE FOR PLACER MINING CLAIM**

NOTICE IS HEREBY GIVEN that the

The "San #2-2 placer mining claim has been located

by Randy Sealey, whose current mailing address is

1127 Victory Ave.,

Billings, Mt. 59105

BLM

Date

Stamp

PHOENIX, ARIZONA

2018 MAR 16 P 12:17

RECEIVED  
BLM AZ STATE OFFICE

The general course of this claim is North-South and it is situated in Maricopa County, Arizona. This claim is 1,320 feet in length and 660 feet in width. This claim runs from the location monument on which this location notice is posted approximately 660 feet in a W direction to the SW corner and 1,320 feet in a N direction to the NW corner.

Four monuments mark this claim, one at each corner.

The location monument on which this notice is posted is situated within Section 2, Township 6 North, Range 4 West, Gila Salt River Base and Meridian, Arizona and this claim encompasses portions of the following quarter section (s), section (s), Township (s) and Range (s) SW  $\frac{1}{4}$  NE  $\frac{1}{4}$  NW  $\frac{1}{4}$  & NW  $\frac{1}{4}$  SE  $\frac{1}{4}$  NW  $\frac{1}{4}$  of Section 2, T6N, R4W Gila Salt River Base and Meridian, Arizona. The locality of this claim with reference to some natural object or permanent monument and additional information (if any) concerning its locality are as follows: This claim is located approximately 3,000' NE of the US Survey Marker located on the SW corner of Section 2 with the wash running NE to SW through the claim.

DATED AND POSTED on the ground this 15<sup>th</sup> day of March, 2018.

LOCATOR: Randy Sealey

Signatures \_\_\_\_\_

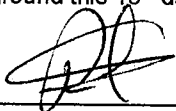

Form MCFIOO  
Revised July 2005

AHC450030

RECEIVED  
BLM AZ STATE OFFICE  
2018 MAR 16 PM 12:17  
PHOENIX, ARIZONA  
Lodge Placer

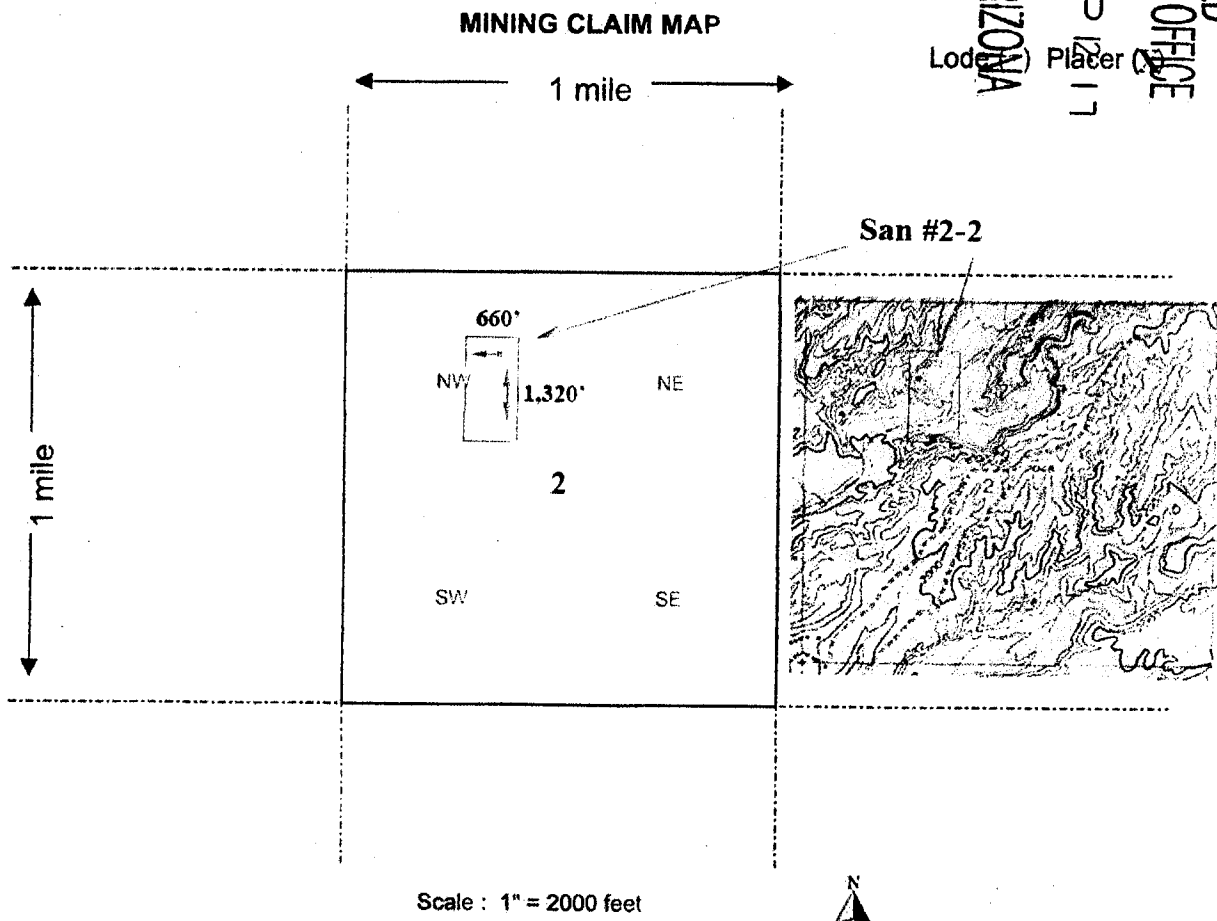

1. The above map depicts the San #2-2 mining claim, which is located in Section (s) 2, Township 6 N, Range 4 W, Gila and Salt River Base and Meridian, Maricopa County, Arizona.
2. The type of corner and location monuments used are as follows: 1 1/2" Poly Pipe, 4 feet long/ cap
3. The bearings and distances in degrees and feet between claim corners are as depicted on the map.

Form MCF100a  
Revised July 2005

This form is available from the Arizona Department of Mines & Mineral Resources and may be reproduced.

AHC450030

**LOCATION NOTICE FOR PLACER MINING CLAIM**

NOTICE IS HEREBY GIVEN that the

The "San #2-3 placer mining claim has been located

by Randy Sealey, whose current mailing address is

1127 Victory Ave.,

Billings, Mt. 59105

BLM

Date

Stamp

PHOENIX, ARIZONA

2018 MAR 16 P 12:17

RECEIVED  
BLM AZ STATE OFFICE

The general course of this claim is North-South and it is situated in Maricopa County, Arizona. This claim is 1,320 feet in length and 660 feet in width. This claim runs from the location monument on which this location notice is posted approximately 660 feet in a W direction to the SW corner and 1,320 feet in a N direction to the NW corner.

Four monuments mark this claim, one at each corner.

The location monument on which this notice is posted is situated within Section 2, Township 6 North, Range 4 West, Gila Salt River Base and Meridian, Arizona and this claim encompasses portions of the following quarter section (s), section (s), Township (s) and Range (s) E1/2 SW 1/4 NW 1/4 of Section 2, T6N, R4W Gila Salt River Base and Meridian, Arizona. The locality of this claim with reference to some natural object or permanent monument and additional information (if any) concerning its locality are as follows: This claim is located approximately 2,700' NE of the US Survey Marker located on the SW corner of Section 2 with the wash running NE to SW through the claim.

DATED AND POSTED on the ground this 15<sup>th</sup> day of March, 2018.

LOCATOR: Randy Sealey

Signatures \_\_\_\_\_

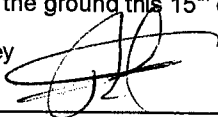

Form MCFIOO  
Revised July 2005

AHC450031



RECEIVED  
BLM AZ STATE OFFICE  
2018 MAR 16 P 12:17  
PHOENIX, ARIZONA  
Lode ( ) Placer (X)

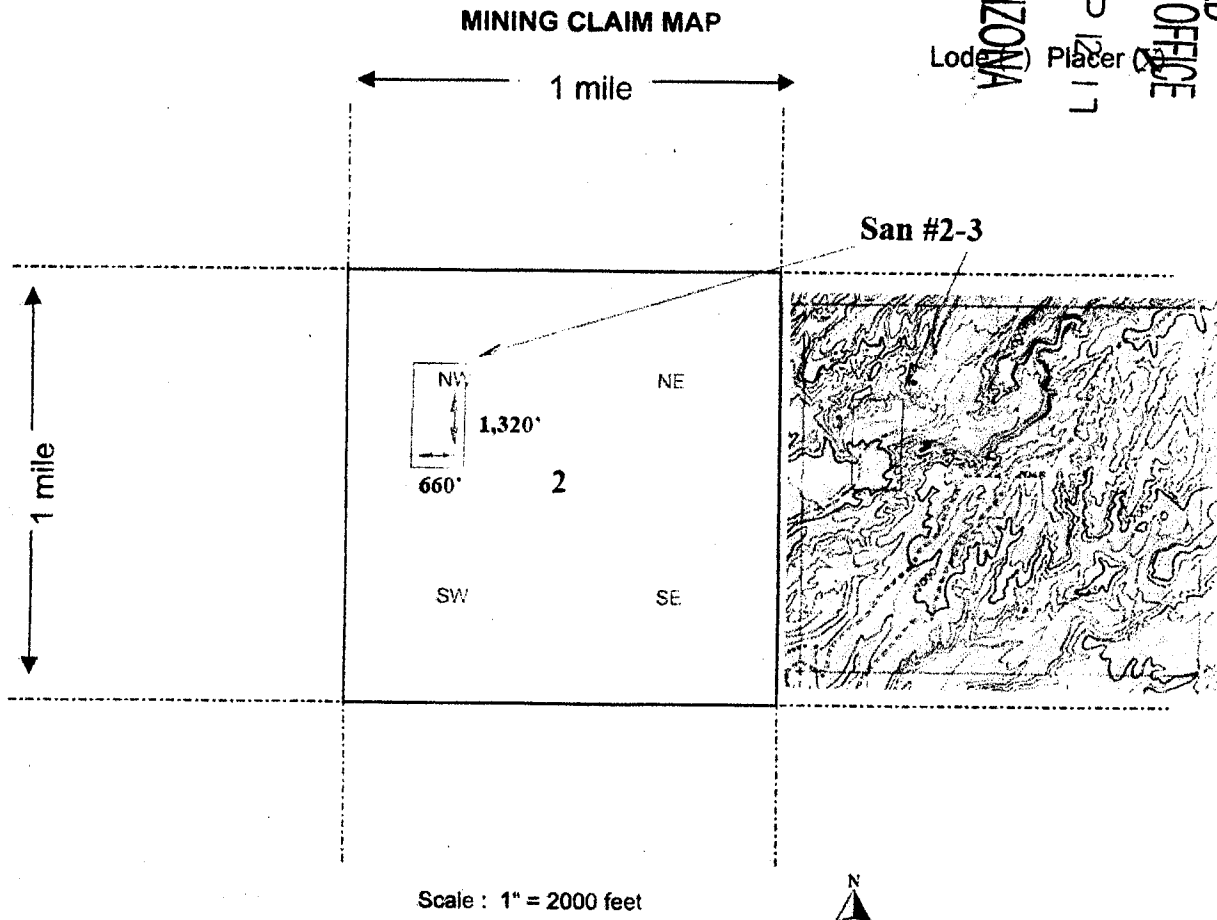

1. The above map depicts the San #2-3 mining claim, which is located in Section (s) 2, Township 6 N, Range 4 W, Gila and Salt River Base and Meridian, Maricopa County, Arizona.
2. The type of corner and location monuments used are as follows: 1 1/2" Poly Pipe, 4 feet long/ cap
3. The bearings and distances in degrees and feet between claim corners are as depicted on the map.

Form MCF100a  
Revised July 2005

This form is available from the Arizona Department of Mines & Mineral Resources and may be reproduced.

AHC450031

**LOCATION NOTICE FOR PLACER MINING CLAIM**

NOTICE IS HEREBY GIVEN that the

The "San #2-4 placer mining claim has been located

by Randy Sealey, whose current mailing address is

1127 Victory Ave.,

Billings, Mt. 59105

BLM

Date

Stamp

RECEIVED  
BLM AZ STATE OFFICE  
PHOENIX, ARIZONA

2018 MAR 16 P 12:17

The general course of this claim is North-South and it is situated in Maricopa County, Arizona. This claim is 660 feet in length and 660 feet in width. This claim runs from the location monument on which this location notice is posted approximately 660 feet in a W direction to the SW corner and 660 feet in a N direction to the NW corner.

Four monuments mark this claim, one at each corner.

The location monument on which this notice is posted is situated within Section 2, Township 6 North, Range 4 West, Gila Salt River Base and Meridian, Arizona and this claim encompasses portions of the following quarter section (s), section (s), Township (s) and Range (s) SW  $\frac{1}{4}$  SW  $\frac{1}{4}$  NW  $\frac{1}{4}$  of Section 2, T6N, R4W Gila Salt River Base and Meridian, Arizona. The locality of this claim with reference to some natural object or permanent monument and additional information (if any) concerning its locality are as follows: This claim is located approximately 2,700' NE of the US Survey Marker located on the SW corner of Section 2 with the wash running through the SE corner of the claim.

DATED AND POSTED on the ground this 15<sup>th</sup> day of March, 2018.

LOCATOR: Randy Sealey

Signatures \_\_\_\_\_

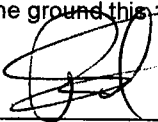

AHC450032

Form MCFIOO  
Revised July 2005

PHOENIX, ARIZONA

2016 MAR 16 P 11 17

RECEIVED  
BLM AZ STATE OFFICE

RECEIVED

MINING CLAIM MAP

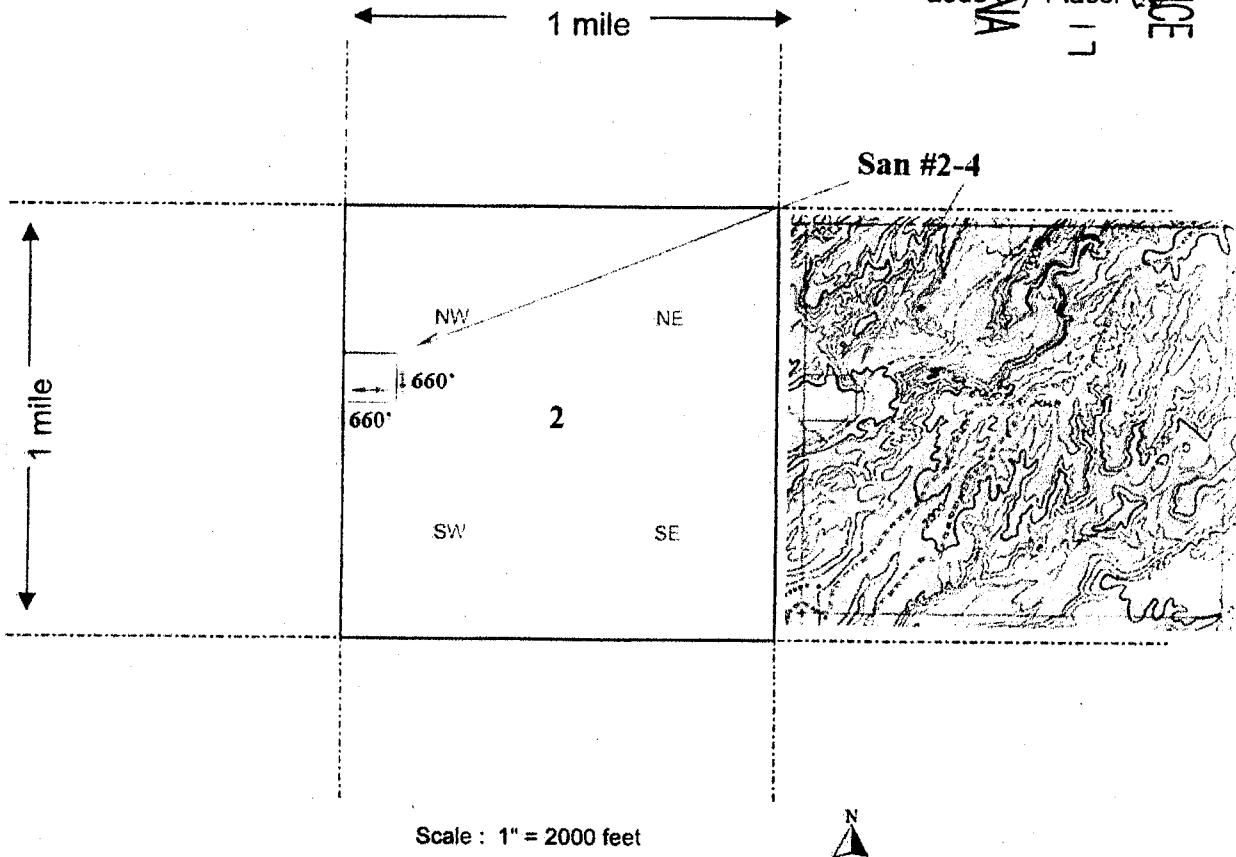

Scale : 1" = 2000 feet



1. The above map depicts the San #2-4 mining claim, which is located in Section (s) 2, Township 6 N, Range 4 W, Gila and Salt River Base and Meridian, Maricopa County, Arizona.
2. The type of corner and location monuments used are as follows: 1 1/2" Poly Pipe, 4 feet long/ cap
3. The bearings and distances in degrees and feet between claim corners are as depicted on the map.

Form MCF100a  
Revised July 2005

This form is available from the Arizona Department of Mines & Mineral Resources and may be reproduced.

AHC450032



**LOCATION NOTICE FOR PLACER MINING CLAIM**

NOTICE IS HEREBY GIVEN that the

The "San #2-5 placer mining claim has been located

by Randy Sealey, whose current mailing address is

1127 Victory Ave.,

Billings, Mt. 59105

BLM

Date

Stamp

PHOENIX, ARIZONA

2018 MAR 16 P 12:17

RECEIVED  
BLM AZ STATE OFFICE

The general course of this claim is East-West and it is situated in Maricopa County, Arizona. This claim is 1,320 feet in length and 660 feet in width. This claim runs from the location monument on which this location notice is posted approximately 1,320 feet in a W direction to the SW corner and 660 feet in a N direction to the NW corner.

Four monuments mark this claim, one at each corner.

The location monument on which this notice is posted is situated within Section 2, Township 6 North, Range 4 West, Gila Salt River Base and Meridian, Arizona and this claim encompasses portions of the following quarter section (s), section (s), Township (s) and Range (s) NW  $\frac{1}{4}$  SW  $\frac{1}{4}$  NE  $\frac{1}{4}$  & NE  $\frac{1}{4}$  SE  $\frac{1}{4}$  NW  $\frac{1}{4}$  of Section 2, T6N, R4W Gila Salt River Base and Meridian, Arizona. The locality of this claim with reference to some natural object or permanent monument and additional information (If any) concerning its locality are as follows: This claim is located approximately 2.4 miles SW of San Domingo Peak & approximately 3,500' NW of the US Survey Marker located on the SE corner of Section 2 with the wash running NE to SW through the claim.

DATED AND POSTED on the ground this 14<sup>th</sup> day of March, 2018.

LOCATOR: Randy Sealey

Signatures \_\_\_\_\_

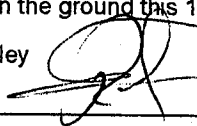

AHC450033

Form MCFIOO  
Revised July 2005

RECEIVED  
BLM AZ STATE OFFICE  
2018 MAR 16 PM 2:17  
PHOENIX, ARIZONA  
Lode Placer

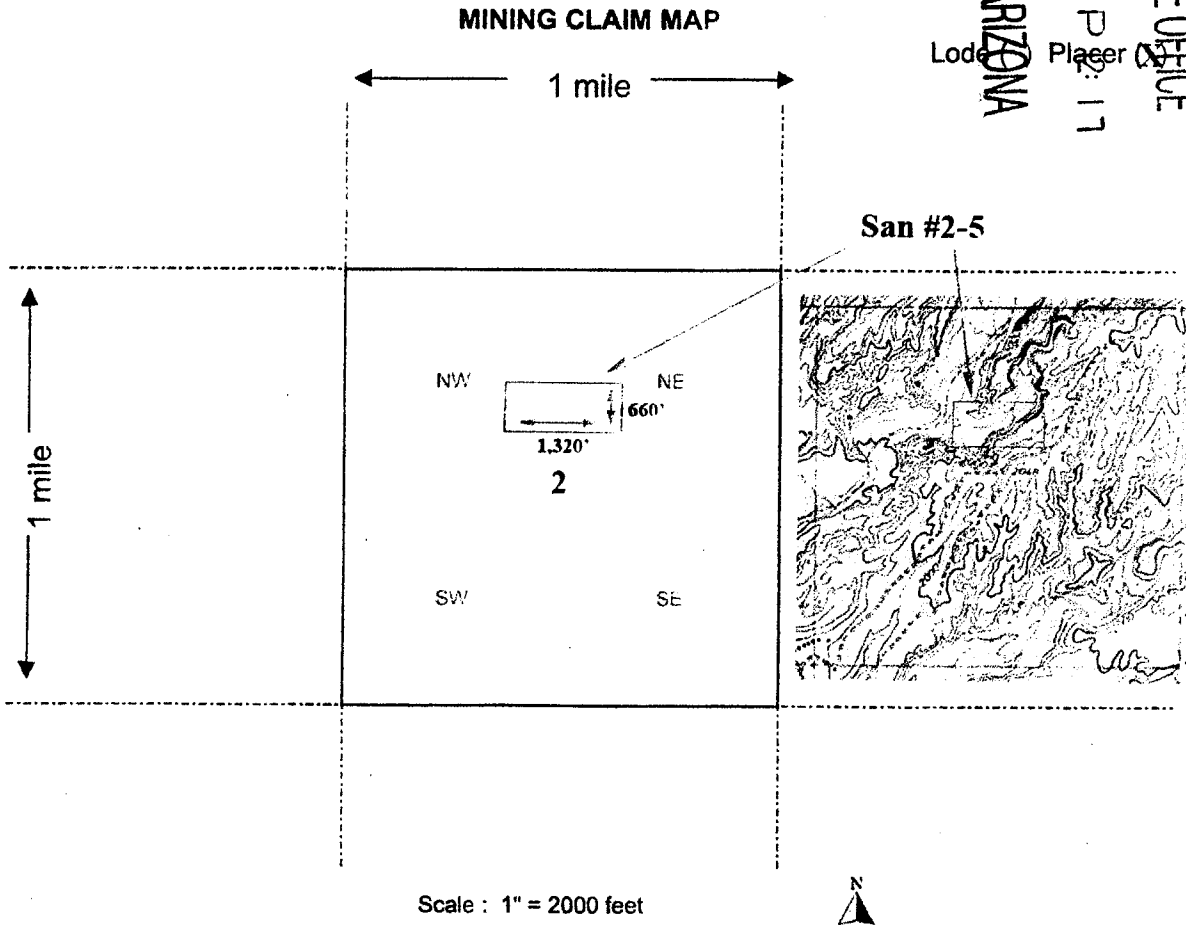

1. The above map depicts the San #2-5 mining claim, which is located in Section (s) 2, Township 6 N, Range 4 W, Gila and Salt River Base and Meridian, Maricopa County, Arizona.
2. The type of corner and location monuments used are as follows: 1 1/2" Poly Pipe, 4 feet long/ cap
3. The bearings and distances in degrees and feet between claim corners are as depicted on the map.

Form MCF100a  
Revised July 2005

This form is available from the Arizona Department of Mines & Mineral Resources and may be reproduced.

AHC450033

**LOCATION NOTICE FOR PLACER MINING CLAIM**

NOTICE IS HEREBY GIVEN that the

The "San #35-0" placer mining claim has been located

by Randy Sealey & Trish Edwards, whose current mailing address is

1127 Victory Ave.,

Billings, Mt. 59105

BLM

Date

Stamp

PHOENIX, ARIZONA

2018 MAR 16 P 12:17

RECEIVED  
BLM AZ STATE OFFICE

The general course of this claim is North-South and it is situated in Maricopa County, Arizona. This claim is 1,320 feet in length and 1,320 feet in width. This claim runs from the location monument on which this location notice is posted approximately 1,320 feet in a W direction to the SW corner and 1,320 feet in a N direction to the NW corner.

Four monuments mark this claim, one at each corner.

The location monument on which this notice is posted is situated within Section 35, Township 7 North, Range 4 West, Gila Salt River Base and Meridian, Arizona and this claim encompasses portions of the following quarter section (s), section (s), Township (s) and Range (s) NW ¼ of the NE ¼ of Section 35, T7N, R4W Gila Salt River Base and Meridian, Arizona. The locality of this claim with reference to some natural object or permanent monument and additional information (if any) concerning its locality are as follows: This claim is located approximately 1.25 miles SW of San Domingo Peak & approximately 2,600' SE of the US Survey Marker located between Sections 26, 27, 34 & 35 with the wash running NE to SW through the claim.

DATED AND POSTED on the ground this 14<sup>th</sup> day of March, 2018.

LOCATORS: Trish Edwards & Randy Sealey

Signatures

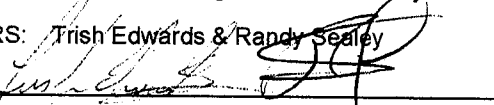

AMC450034

Form MCFIOO  
Revised July 2005



PHOENIX, ARIZONA

2018 MAR 16 P 12:17

RECEIVED  
BLM AZ STATE OFFICE

Lode ☒ Placer ☒

MINING CLAIM MAP

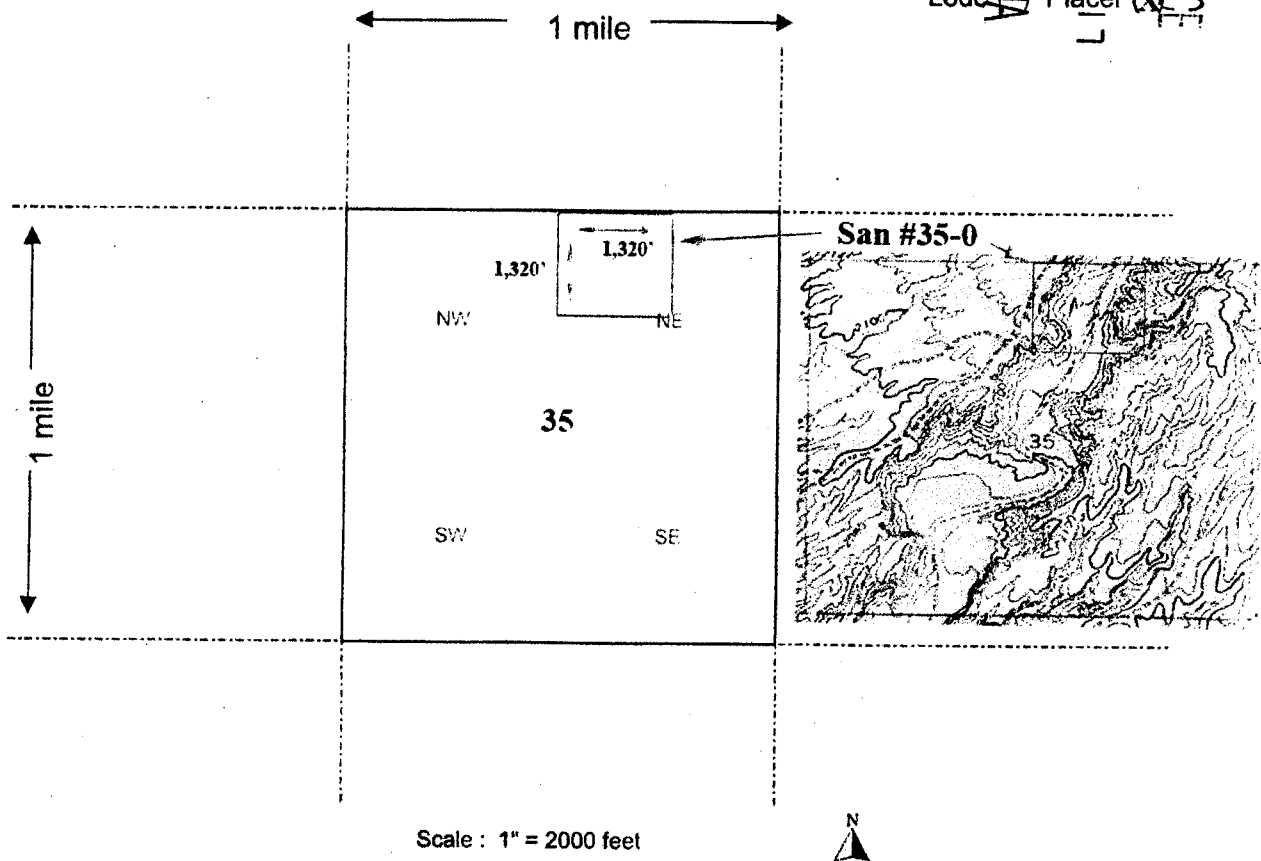

Scale : 1" = 2000 feet



1. The above map depicts the San #35-0 mining claim, which is located in Section (s) 35, Township 7 N, Range 4 W, Gila and Salt River Base and Meridian, Maricopa County, Arizona.
2. The type of corner and location monuments used are as follows: 1 1/2" Poly Pipe, 4 feet long/ cap
3. The bearings and distances in degrees and feet between claim corners are as depicted on the map.

Form MCF100a  
Revised July 2005

This form is available from the Arizona Department of Mines & Mineral Resources and may be reproduced.

AHC450034

**LOCATION NOTICE FOR PLACER MINING CLAIM**

NOTICE IS HEREBY GIVEN that the

The "San #35-1" placer mining claim has been located

by Randy Sealey & Trish Edwards, whose current mailing address is

1127 Victory Ave.,

Billings, Mt. 59105

BLM

Date

Stamp

PHOENIX, ARIZONA

2018 MAR 16 P 12:17

RECEIVED  
BLM AZ STATE OFFICE

The general course of this claim is North South and it is situated in Maricopa County, Arizona. This claim is 1,320 feet in length and 1,320 feet in width. This claim runs from the location monument on which this location notice is posted approximately 1,320 feet in a W direction to the SW corner and 1,320 feet in a N direction to the NW corner.

Four monuments mark this claim, one at each corner.

The location monument on which this notice is posted is situated within Section 35, Township 7 North, Range 4 West, Gila Salt River Base and Meridian, Arizona and this claim encompasses portions of the following quarter section (s), section (s), Township (s) and Range (s) E  $\frac{1}{2}$  SE  $\frac{1}{4}$  NW  $\frac{1}{4}$ , W  $\frac{1}{2}$  SW  $\frac{1}{4}$  NE  $\frac{1}{4}$  of Section 35, T7N, R4W Gila Salt River Base and Meridian, Arizona. The locality of this claim with reference to some natural object or permanent monument and additional information (If any) concerning its locality are as follows: This claim is located approximately 1.5 miles SW of San Domingo Peak & approximately 2,000' SE of the US Survey Marker located between Sections 26, 27, 34 & 35 with the wash running NE to SW through the claim.

DATED AND POSTED on the ground this 12<sup>th</sup> day of March, 2018.

LOCATORS: Trish Edwards & Randy Sealey

Signatures

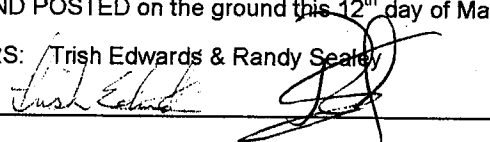

AMC450035

Form MCFIOO  
Revised July 2005

RECEIVED  
BLM AZ STATE OFFICE  
2018 MAR 16 P 11:17  
PHOENIX, ARIZONA  
Lodg ( ) Placer ( )

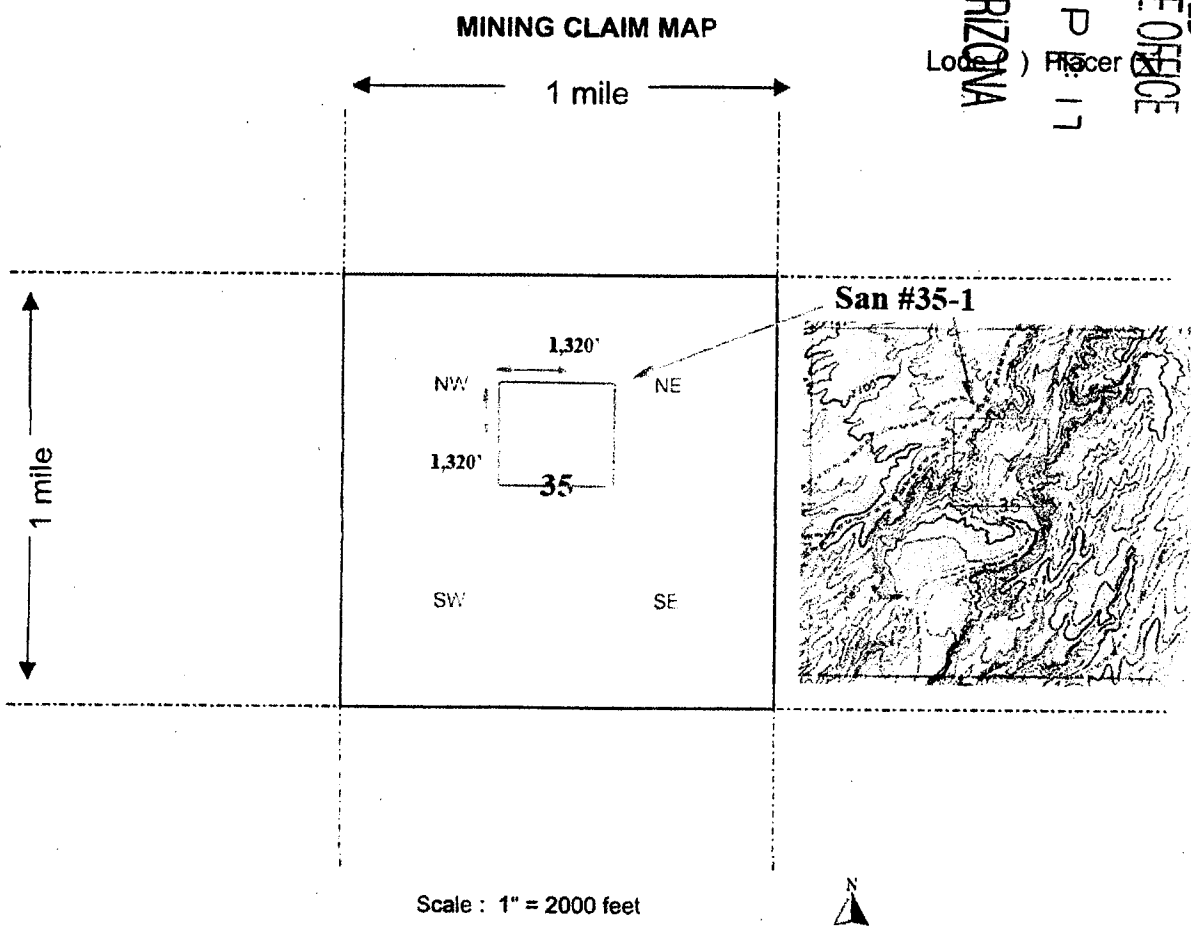

1. The above map depicts the San #35-1 mining claim, which is located in Section (s) 35, Township 7 N, Range 4 W, Gila and Salt River Base and Meridian, Maricopa County, Arizona.
2. The type of corner and location monuments used are as follows: 1 1/2" Poly Pipe, 4 feet long/ cap
3. The bearings and distances in degrees and feet between claim corners are as depicted on the map.

Form MCF100a  
Revised July 2005

This form is available from the Arizona Department of Mines & Mineral Resources and may be reproduced.

AHC450035



RECEIVED  
BLM AZ STATE OFFICE

2018 MAR 16 P 12:18

PHOENIX, ARIZONA

# LOCATION NOTICE FOR PLACER MINING CLAIM

NOTICE IS HEREBY GIVEN that the

The "San #35-2" placer mining claim has been located

by Randy Sealey & Trish Edwards, whose current mailing address is

1127 Victory Ave.,

Billings, Mt. 59105

BLM

Date

Stamp

The general course of this claim is North-South and it is situated in Maricopa County, Arizona. This claim is 1,320 feet in length and 1,320 feet in width. This claim runs from the location monument on which this location notice is posted approximately 1,320 feet in a W direction to the SW corner and 1,320 feet in a N direction to the NW corner.

Four monuments mark this claim, one at each corner.

The location monument on which this notice is posted is situated within Section 35, Township 7 North, Range 4 West, Gila Salt River Base and Meridian, Arizona and this claim encompasses portions of the following quarter section (s), section (s), Township (s) and Range (s) NE ¼, SW ¼ of Section 35, T7N, R4W Gila Salt River Base and Meridian, Arizona. The locality of this claim with reference to some natural object or permanent monument and additional information (if any) concerning its locality are as follows: This claim is located approximately 1.75 miles SW of San Domingo Peak & approximately 2,700' SE of the US Survey Marker located between Sections 26, 27, 34 & 35 with the wash running NE to SW through the claim.

DATED AND POSTED on the ground this 12<sup>th</sup> day of March, 2018.

LOCATORS: Trish Edwards & Randy Sealey

Signatures

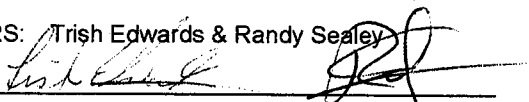

AHC450036

Form MCFIOO  
Revised July 2005

RECEIVED  
BLM AZ STATE OFFICE  
2018 MAR 16 PM 2:18  
PHOENIX, ARIZONA  
Lode ( ) Placer ( )

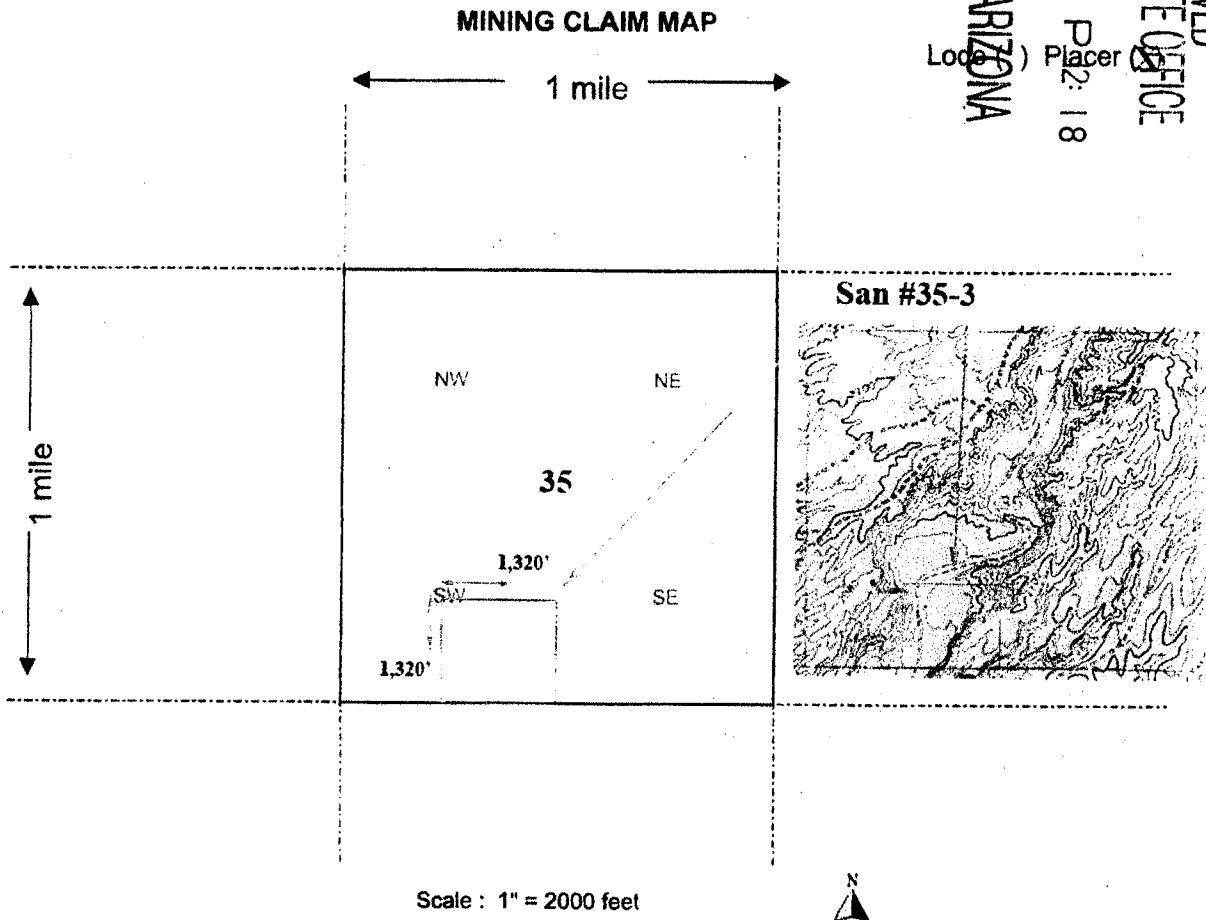

1. The above map depicts the San #35-3 mining claim, which is located in Section (s) 35, Township 7 N, Range 4 W, Gila and Salt River Base and Meridian, Maricopa County, Arizona.
2. The type of corner and location monuments used are as follows: 1 1/2" Poly Pipe, 4 feet long/ cap
3. The bearings and distances in degrees and feet between claim corners are as depicted on the map.

Form MCF100a  
Revised July 2005

This form is available from the Arizona Department of Mines & Mineral Resources and may be reproduced.

AHC450036

**Amended Location Notice/ (Map) for AMC450036 - "San #35-2"**

**LOCATION NOTICE FOR PLACER MINING CLAIM**

NOTICE IS HEREBY GIVEN that the

The "San #35-2" placer mining claim has been located

by Randy Sealey & Trish Edwards, whose current mailing address is

1127 Victory Ave.,

Billings, Mt. 59105

BLM

Date

Stamp

PHOENIX, ARIZONA

2018 MAR 16 P 12:18

RECEIVED  
BLM AZ STATE OFFICE

The general course of this claim is North-South and it is situated in Maricopa County, Arizona. This claim is 1,320 feet in length and 1,320 feet in width. This claim runs from the location monument on which this location notice is posted approximately 1,320 feet in W direction to the SW corner and 1,320 feet in a N direction to the NW corner. Four monuments mark this claim, one at each corner.

PHOENIX, ARIZONA

2018 SEP 14 P 2:10

RECEIVED  
BLM AZ STATE OFFICE

The location monument on which this notice is posted is situated within Section 35, Township 7 North, Range 4 West, Gila Salt River Base and Meridian, Arizona and this claim encompasses portions of the following quarter section (s), section (s), Township (s) and Range (s) NE ¼, SW ¼ of Section 35, T7N, R4W Gila Salt River Base and Meridian, Arizona. The locality of this claim with reference to some natural object or permanent monument and additional information (If any) concerning its locality are as follows: This claim is located approximately 1.75 miles SW of San Domingo Peak & approximately 2,700' SE of the US Survey Marker located between Sections 26, 27, 34 & 35 with the wash running NE to SW through the claim.

DATED AND POSTED on the ground this 12<sup>th</sup> day of March, 2018.

LOCATORS: Trish Edwards & Randy Sealey

Signatures

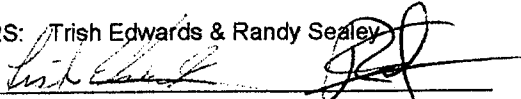

#4264451

Form MCFIOO  
Revised July 2005

AMC450036



RECEIVED  
BLM AZ STATE OFFICE  
2018 MAR 16 8 12:18  
PHOENIX, ARIZONA  
Lode Placer X

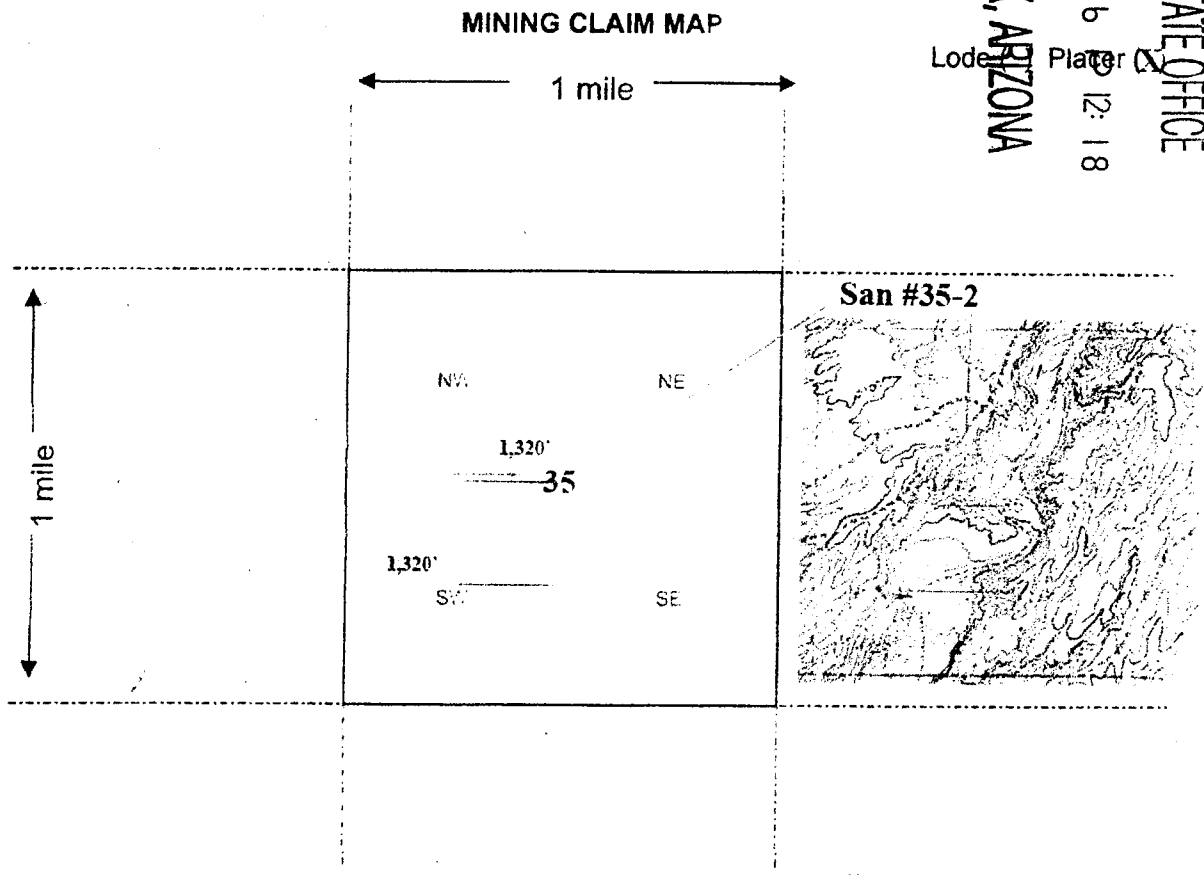

Scale : 1" = 2000 feet



1. The above map depicts the San #35-2 mining claim, which is located in Section (s) 35, Township 7 N, Range 4 W, Gila and Salt River Base and Meridian, Maricopa County, Arizona.
2. The type of corner and location monuments used are as follows: 1 1/2" Poly Pipe, 4 feet long/ cap
3. The bearings and distances in degrees and feet between claim corners are as depicted on the map.

Form MCF100a  
Revised July 2005

This form is available from the Arizona Department of Mines & Mineral Resources and may be reproduced.

Amc450036

**LOCATION NOTICE FOR PLACER MINING CLAIM**

NOTICE IS HEREBY GIVEN that the

The "San #35-3" placer mining claim has been located

by Randy Sealey & Trish Edwards, whose current mailing address is

1127 Victory Ave.,

Billings, Mt. 59105

BLM

Date

Stamp

PHOENIX, ARIZONA

2018 MAR 16 P 12:18

RECEIVED  
BLM AZ STATE OFFICE

The general course of this claim is North-South and it is situated in Maricopa County, Arizona. This claim is 1,320 feet in length and 1,320 feet in width. This claim runs from the location monument on which this location notice is posted approximately 1,320 feet in a W direction to the SW corner and 1,320 feet in a N direction to the NW corner.

Four monuments mark this claim, one at each corner.

The location monument on which this notice is posted is situated within Section 35, Township 7 North, Range 4 West, Gila Salt River Base and Meridian, Arizona and this claim encompasses portions of the following quarter section (s), section (s), Township (s) and Range (s) SE  $\frac{1}{4}$ , SW  $\frac{1}{4}$  of Section 35, T7N, R4W Gila Salt River Base and Meridian, Arizona. The locality of this claim with reference to some natural object or permanent monument and additional information (If any) concerning its locality are as follows: This claim is located approximately 2 miles SW of San Domingo Peak & approximately 4,000' SE of the US Survey Marker located between Sections 26, 27, 34 & 35 with the wash running NE to SW through the claim.

DATED AND POSTED on the ground this 12<sup>th</sup> day of March, 2018.

LOCATORS: Trish Edwards & Randy Sealey

Signatures



AMC450037

Form MCFIOO  
Revised July 2005

RECEIVED  
BLM AZ STATE OFFICE  
2018 MAR 16 9 12:18  
PHOENIX, ARIZONA  
Lode Placer X

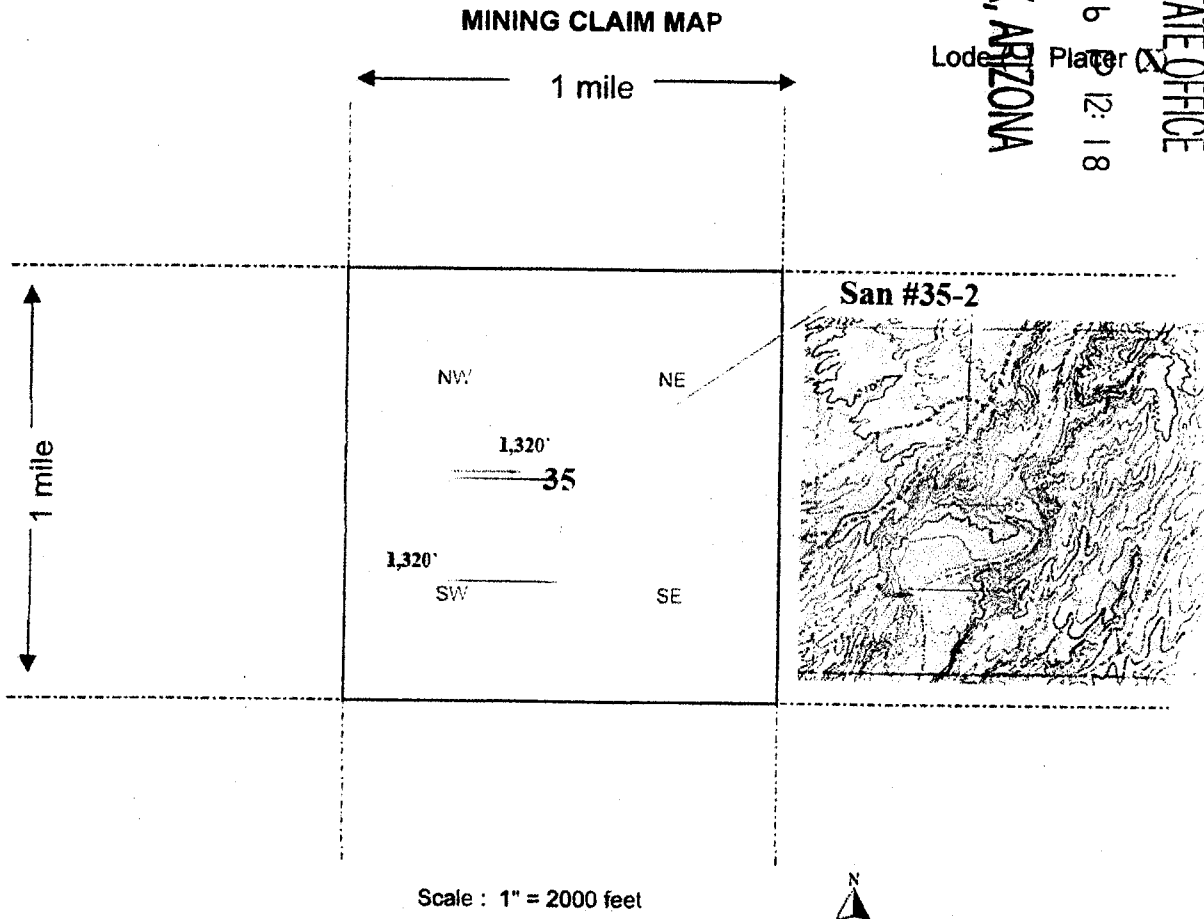

1. The above map depicts the San #35-2 mining claim, which is located in Section (s) 35, Township 7 N, Range 4 W, Gila and Salt River Base and Meridian, Maricopa County, Arizona.
2. The type of corner and location monuments used are as follows: 1 1/2" Poly Pipe, 4 feet long/ cap
3. The bearings and distances in degrees and feet between claim corners are as depicted on the map.

Form MCF100a  
Revised July 2005

This form is available from the Arizona Department of Mines & Mineral Resources and may be reproduced.

AHC450037

# Amended Location Notice/ (Map) for AMC450037 - "San #35-3"

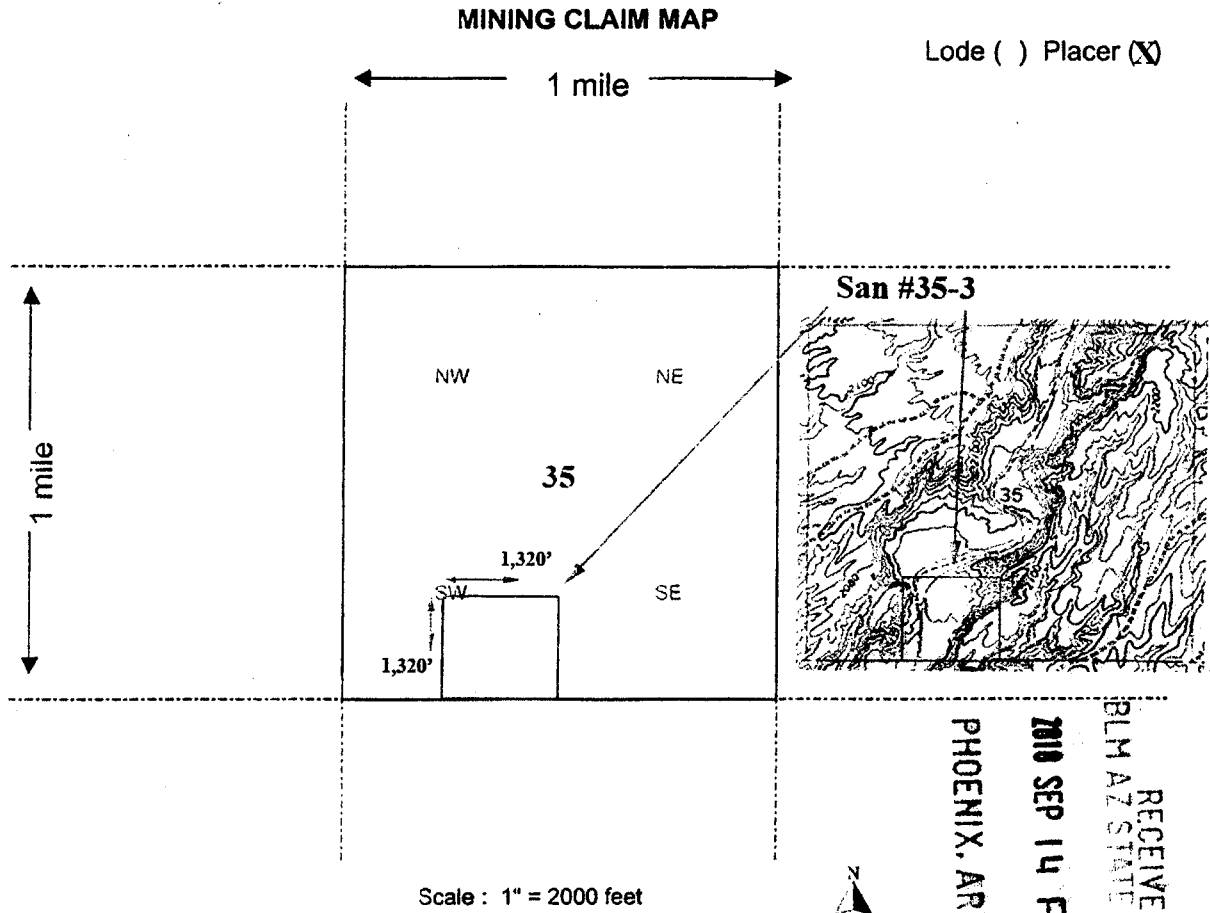

1. The above map depicts the San #35-3 mining claim, which is located in Section (s) 35, Township 7 N, Range 4 W, Gila and Salt River Basins and Meridian Maricopa County, Arizona.
2. The type of corner and location monuments used are as follows: 1 1/2" Poly Pipe, 4 feet long/ cap
3. The bearings and distances in degrees and feet between claim corners are as depicted on the map.

Form MCF100a  
Revised July 2005

This form is available from the Arizona Department of Mines & Mineral Resources and may be reproduced.

Amc 450037



**LOCATION NOTICE FOR PLACER MINING CLAIM**

NOTICE IS HEREBY GIVEN that the

The "San #35-4" placer mining claim has been located

by Randy Sealey, whose current mailing address is

1127 Victory Ave.,

Billings, Mt. 59105

BLM

Date

Stamp

PHOENIX, ARIZONA

2018 MAR 16 P 12:18

RECEIVED  
BLM AZ STATE OFFICE

The general course of this claim is North-South and it is situated in Maricopa County, Arizona. This claim is 1,320 feet in length and 660 feet in width. This claim runs from the location monument on which this location notice is posted approximately 660 feet in a W direction to the SW corner and 1,320 feet in a N direction to the NW corner.

Four monuments mark this claim, one at each corner.

The location monument on which this notice is posted is situated within Section 35, Township 7 North, Range 4 West, Gila Salt River Base and Meridian, Arizona and this claim encompasses portions of the following quarter section (s), section (s), Township (s) and Range (s) W1/2 NW1/4 SE1/4 of Section 35, T7N, R4W Gila Salt River Base and Meridian, Arizona. The locality of this claim with reference to some natural object or permanent monument and additional information (If any) concerning its locality are as follows: This claim is located approximately 1.6 miles SW of San Domingo Peak & approximately 2,700' SE of the US Survey Marker located between Sections 26, 27, 34 & 35 with the wash running NE to W through the claim.

DATED AND POSTED on the ground this 14<sup>th</sup> day of March, 2018.

LOCATOR: Randy Sealey

Signatures \_\_\_\_\_

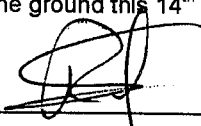

AHC450038

Form MCFIOO  
Revised July 2005

RECEIVED  
BLM AZ STATE OFFICE  
2018 MAR 16 12:18  
PHOENIX, ARIZONA

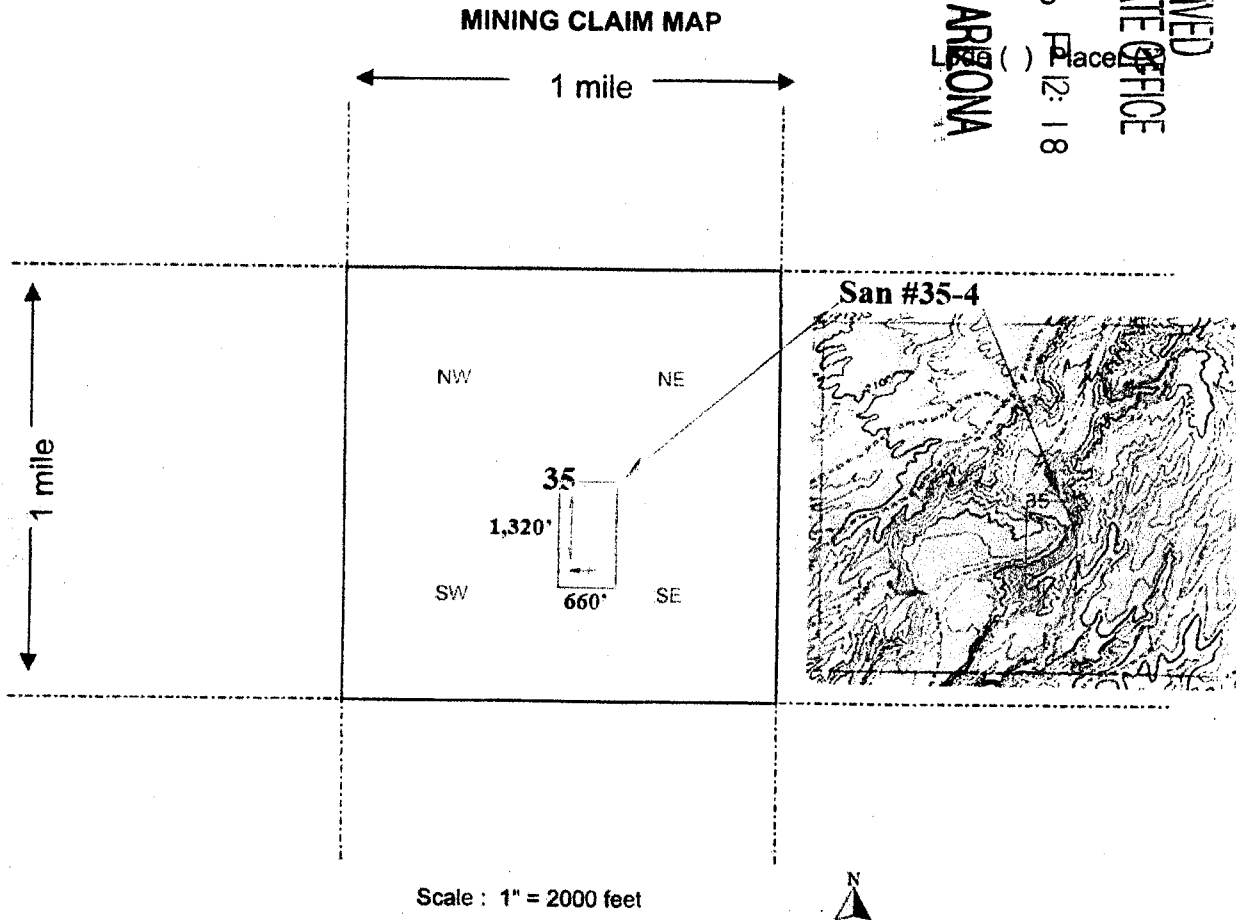

1. The above map depicts the San #35-4 mining claim, which is located in Section (s) 35, Township 7 N, Range 4 W, Gila and Salt River Base and Meridian, Maricopa County, Arizona.
2. The type of corner and location monuments used are as follows: 1 1/2" Poly Pipe, 4 feet long/ cap
3. The bearings and distances in degrees and feet between claim corners are as depicted on the map.

Form MCF100a  
Revised July 2005

This form is available from the Arizona Department of Mines & Mineral Resources and may be reproduced.

AMC450038



LIST NO. T-512

SERIAL NO. 681024

Pat. 1130865

STATE DEPARTMENT DOCKET 624 PAGE 452  
 OFFICE OF THE STATE LAND COMMISSIONER  
 PHOENIX, ARIZONA

RECEIVED  
 SURVEY OFFICE  
 11 1950

DEED OF RECONVEYANCE

KNOW ALL MEN BY THESE PRESENTS: That

WHEREAS THE STATE OF ARIZONA IS THE OWNER AND/OR RESERVEE OF THE LAND HEREINAFTER DESCRIBED:

For and in consideration of the exchange of certain lands as authorized under Section 8 of the Act of June 28, 1934 (48 Stat. 1269), as amended: (base lands used in exchange in Selection List, Number and Serial noted above), the STATE OF ARIZONA does in conformity with the laws of the STATE OF ARIZONA, Section 12 Public Land Code, approved June 25, 1915, as amended by Section 2954 R. C. 1928, herewith remise, release, quitclaim, grant, convey and relinquish to the UNITED STATES OF AMERICA, reserving to the STATE OF ARIZONA all Mineral Deposits and Rights, together with the right to prospect for, mine and remove the same: from lands described as follows:

GILA AND SALT RIVER BASE MERIDIAN—ARIZONA

✓ TOWNSHIP 4 NORTH, RANGE 4 WEST ✓  
 Sec. 36, All ✓  
 ✓ TOWNSHIP 5 NORTH, RANGE 2 WEST ✓  
 Sec. 36, SW $\frac{1}{4}$  ✓  
 ✓ TOWNSHIP 6 NORTH, RANGE 1 WEST ✓  
 Sec. 2, SE $\frac{1}{4}$  ✓  
 ✓ TOWNSHIP 6 NORTH, RANGE 4 WEST ✓  
 Sec. 2, E $\frac{1}{2}$ , NW $\frac{1}{4}$ . ✓  
 ✓ TOWNSHIP 1 SOUTH, RANGE 10 WEST ✓  
 Sec. 2, Lots 3 & 4, S $\frac{1}{2}$ NW $\frac{1}{4}$ . ✓  
 Sec. 16, W $\frac{1}{2}$ SE $\frac{1}{4}$ . ✓  
 ✓ TOWNSHIP 2 SOUTH, RANGE 7 WEST ✓  
 Sec. 16, E $\frac{1}{2}$ NE $\frac{1}{4}$ . ✓  
 ✓ TOWNSHIP 4 SOUTH, RANGE 1 WEST ✓  
 Sec. 2, N $\frac{1}{2}$ . ✓

TO HAVE AND TO HOLD, the hereinbefore described lands, together with all and singular the rights and appurtenances thereto in anywise belonging to the said UNITED STATES OF AMERICA, its successors and assigns forever.

IN WITNESS WHEREOF THE STATE OF ARIZONA has caused this DEED OF RECONVEYANCE to be executed by its duly authorized officers and its GREAT SEAL hereto affixed

this 11th day of September, 1950

INDEXED  
FACED

ATTN



*Samuel H. Jones*  
 Governor of the State of Arizona

*W. L. Wilson*  
 State Land Commissioner of Arizona

*Frederic O. Wilson*  
 Attorney General of the State of Arizona

STATE OF ARIZONA, County of Maricopa; ss.

I do hereby certify that the within instrument was filed and recorded at request of *My State Land Dept.* on *66396* at *M. Docket*

1050 OCT 5 1950

Page *452* Records of Maricopa County, Arizona.

WITNESS my hand and official seal the day and year first above written.

ROGER G. LAYMAN, County Recorder.



## NOTICES

## DEPARTMENT OF THE INTERIOR

## Bureau of Land Management

[Misc. 5-7]

## ARIZONA

## ORDER PROVIDING FOR OPENING OF PUBLIC LANDS

FEBRUARY 15, 1954.

In exchanges of lands made under the provisions of section 8 of the Act of June 28, 1934 (48 Stat. 1269) as amended June 26, 1936 (49 Stat. 1976, 43 U. S. C. sec. 315g), the following described lands have been reconveyed to the United States:

## GILA AND SALT RIVER BASE AND MERIDIAN

T. 6 N., R. 1 W.,  
Sec. 2, SE $\frac{1}{4}$ .  
T. 5 N., R. 2 W.,  
Sec. 36, SW $\frac{1}{4}$ .  
T. 4 N., R. 4 W.,  
Sec. 36.  
T. 6 N., R. 4 W.,  
Sec. 2, E $\frac{1}{2}$ , NW $\frac{1}{4}$ .  
T. 5 N., R. 5 W.,  
Sec. 16.  
T. 3 N., R. 8 W.,  
Sec. 32, NE $\frac{1}{4}$ SE $\frac{1}{4}$ , S $\frac{1}{2}$ SE $\frac{1}{4}$ .  
Sec. 36, NE $\frac{1}{4}$ SE $\frac{1}{4}$ , S $\frac{1}{2}$ SE $\frac{1}{4}$ .  
T. 1 N., R. 7 W.,  
Sec. 2, lots 2, 3, 4, S $\frac{1}{2}$ NW $\frac{1}{4}$ , SW $\frac{1}{4}$ NE $\frac{1}{4}$ ,  
S $\frac{1}{2}$ ,  
Secs. 16 and 32;  
Sec. 36, N $\frac{1}{2}$ , SE $\frac{1}{4}$ .  
T. 3 N., R. 7 W.,  
Sec. 16, NE $\frac{1}{4}$ SE $\frac{1}{4}$ , S $\frac{1}{2}$ SE $\frac{1}{4}$ .  
T. 1 N., R. 8 W.,  
Sec. 16, NE $\frac{1}{4}$ , E $\frac{1}{2}$ NW $\frac{1}{4}$ , S $\frac{1}{2}$ .  
Sec. 32.  
T. 1 N., R. 9 W.,  
Secs. 16 and 32.  
T. 10 N., R. 9 W.,  
Sec. 16, W $\frac{1}{2}$ .  
T. 9 N., R. 10 W.,  
Sec. 2, NE $\frac{1}{4}$ , NE $\frac{1}{4}$ NW $\frac{1}{4}$ , S $\frac{1}{2}$ NW $\frac{1}{4}$ , S $\frac{1}{2}$ .  
T. 10 N., R. 10 W.,  
Sec. 16, NW $\frac{1}{4}$ SW $\frac{1}{4}$ .  
T. 10 N., R. 13 W.,  
Sec. 16, W $\frac{1}{2}$ NW $\frac{1}{4}$ , SE $\frac{1}{4}$ .  
T. 1 N., R. 14 W.,  
Sec. 32, S $\frac{1}{2}$ NW $\frac{1}{4}$ , SW $\frac{1}{4}$ .  
T. 2 N., R. 14 W.,  
Sec. 32;  
Sec. 36, N $\frac{1}{2}$ S $\frac{1}{2}$ , S $\frac{1}{2}$ SE $\frac{1}{4}$ .  
T. 14 N., R. 14 W.,  
Sec. 32, E $\frac{1}{2}$ SE $\frac{1}{4}$ .  
T. 16 N., R. 14 W.,  
Sec. 15.  
T. 7 N., R. 15 W.,  
Sec. 16, W $\frac{1}{2}$ SE $\frac{1}{4}$ .  
T. 12 N., R. 16 W.,  
Sec. 5, lots 1 and 2;  
Sec. 7, lot 4, E $\frac{1}{2}$ W $\frac{1}{2}$ , E $\frac{1}{2}$ .  
Secs. 9, 11, 13, 15 and 17.  
T. 16 $\frac{1}{2}$  N., R. 16 W.,  
Sec. 32, SE $\frac{1}{4}$ SE $\frac{1}{4}$ .  
T. 17 N., R. 16 W.,  
Sec. 36, E $\frac{1}{2}$ NE $\frac{1}{4}$ .  
T. 18 N., R. 16 W.,  
Sec. 2, SE $\frac{1}{4}$ SE $\frac{1}{4}$ .  
T. 7 N., R. 17 W.,  
Sec. 36.  
T. 28 N., R. 19 W.,  
Sec. 16, N $\frac{1}{2}$ , SW $\frac{1}{4}$ .  
Secs. 36 and 32.  
T. 27 N., R. 20 W.,  
Sec. 30, SE $\frac{1}{4}$ NW $\frac{1}{4}$ , NE $\frac{1}{4}$ SW $\frac{1}{4}$ .  
T. 4 S., R. 1 W.,  
Sec. 2, N $\frac{1}{2}$ .  
T. 2 S., R. 7 W.,  
Sec. 16, E $\frac{1}{2}$ NE $\frac{1}{4}$ .

T. 6 S., R. 7 W.,  
Sec. 32, NW $\frac{1}{4}$ SW $\frac{1}{4}$ , S $\frac{1}{2}$ SW $\frac{1}{4}$ , SE $\frac{1}{4}$ .  
T. 1 S., R. 10 W.,  
Sec. 2, lots 3, 4, S $\frac{1}{2}$ NW $\frac{1}{4}$ .  
Sec. 16, W $\frac{1}{2}$ SE $\frac{1}{4}$ .  
T. 4 S., R. 12 W.,  
Sec. 36, SW $\frac{1}{4}$ NW $\frac{1}{4}$ .  
T. 7 S., R. 1 E.,  
Sec. 4, lots 1 and 2.

No applications for these lands may be allowed under the homestead, small tract, desert-land or any other non-mineral public-land laws unless the lands have already been classified as valuable or suitable for such type of application, or shall be so classified upon consideration of an application. Most of the lands are rough and mountainous and not suitable for cultivation. However, the lands in T. 1 N., Rs. 7, 8, 9 W., T. 2 N., R. 14 W., T. 3 N., Rs. 6, 7 W., T. 4 N., R. 4 W., T. 5 N., Rs. 2, 5 W., T. 2 S., R. 7 W., T. 4 S., Rs. 1, 12 W., T. 6 S., R. 7 W., and T. 7 S., R. 1 E., are in areas where interest has been shown in development of lands for agricultural purposes. Each application filed on lands described in this order will be considered on its merits.

This order shall not otherwise become effective to change the status of such lands until 10:00 a. m. on the 35th day after the date of this order. At that time the said lands shall, subject to valid existing rights and the provisions of existing withdrawals, become subject to application, petition, location, and selection as follows:

(a) *Ninety-one day period for preference-right filings.* For a period of 91 days, commencing at the hour and on the day specified above, the public lands affected by this order shall be subject only to (1) application under the homestead or the desert-land laws or the Small Tract Act of June 1, 1938, 52 Stat. 609 (43 U. S. C. 682a) as amended, by qualified veterans of World War II and other qualified persons entitled to preference under the act of September 27, 1944, 58 Stat. 747 (43 U. S. C. 279-284), as amended, subject to the requirements of applicable law, and (2) application under any applicable public-land law, based on prior existing valid settlement rights and preference rights conferred by existing laws or equitable claims subject to allowance and confirmation. Applications under subdivision (1) of this paragraph shall be subject to applications and claims of the classes described in subdivision (2) of this paragraph. All applications filed under this paragraph either at or before 10:00 a. m. on the 35th day after the date of this order shall be treated as though filed simultaneously at that time. All applications filed under this paragraph after 10:00 a. m. on the said 35th day shall be considered in the order of filing.

(b) *Date for non-preference-right filings.* Commencing at 10:00 a. m. on the 126th day after the date of this order, any lands remaining unappropriated shall become subject to such application, petition, location, selection, or other appropriation by the public generally as

may be authorized by the public-land laws. All such applications filed either at or before 10:00 a. m. on the 126th day after the date of this order, shall be treated as though filed simultaneously at the hour specified on such 126th day. All applications filed thereafter shall be considered in the order of filing.

A veteran shall accompany his application with a complete photostatic, or other copy (both sides) of his certificate of honorable discharge, or of an official document of his branch of the service which shows clearly his honorable discharge as defined in § 181.36 of Title 43 of the Code of Federal Regulations, or constitutes evidence of other facts upon which the claim for preference is based and which shows clearly the period of service. Other persons claiming credit for service of veterans must furnish like proof in support of their claims. Persons asserting preference rights, through settlement or otherwise, and those having equitable claims, shall accompany their applications by duly corroborated statements in support thereof, setting forth in detail all facts relevant to their claims.

Applications for these lands, which shall be filed in the Land and Survey Office, Phoenix, Arizona, shall be acted upon in accordance with the regulations contained in § 295.8 of Title 43 of the Code of Federal Regulations and Part 296 of that title, to the extent that such regulations are applicable. Applications under the homestead laws shall be governed by the regulations contained in Parts 166 to 170, inclusive, of Title 43 of the Code of Federal Regulations, and applications under the desert-land laws and the said Small Tract Act of June 1, 1938, shall be governed by the regulations contained in Parts 232 and 257, respectively, of that title.

Inquiries concerning these lands shall be addressed to the Manager, Land and Survey Office, Phoenix, Arizona.

E. R. SMITH,  
Regional Administrator

[F. R. Doc. 54-1230; Filed, Feb. 23, 1954;  
8:45 a. m.]

## UTAH

## NOTICE OF PROPOSED WITHDRAWAL AND RESERVATION OF LANDS

FEBRUARY 15, 1954.

An application, serial number Utah 010641, for the withdrawal from all forms of appropriation under the public land laws, of the lands described below was filed on October 28, 1953, by the City of Vernal, Utah.

The purposes of the proposed withdrawal: Watershed protection—city water supply.

For a period of 60 days from the date of publication of this notice, persons having cause to object to the proposed withdrawal may present their objections in writing to the Regional Administrator, Region IV Bureau of Land Management, Department of the Interior, at Post Office



## TOWNSHIP 06 NORTH RANGE 04 WEST OF THE GILA &amp; SALT RIVER MERIDIAN, ARIZONA

SECS	SUBDIVISION																Acres	Kind of Entry or Purpose	Serial Number or Order Number	Action Date	Remarks		
	NE 1/4				NW 1/4				SW 1/4				SE 1/4									Lots	Other Description
	NE	NW	SW	SE	NE	NW	SW	SE	NE	NW	SW	SE	NE	NW	SW	SE							
For orders affecting disposal or use of unidentified lands withdrawn for classification, minerals, water, and/or other public purposes, and Indian treaties, refer to Index to Miscellaneous Documents																							
26					X			X	X				X										
27		X	X		X	X	X	X	X	X	X	X		X	X								
34	X	X	X	X	X	X	X	X	X	X	X		X	X	X	X							
35																		ALL;	SO WDL HASSAYAMPA PROJECT	7/25/1941	WITHDRAWN FROM PUBLIC ENTRY UNDER THE FIRST FORM WITHDRAWAL; LD TP: 4N 3W; SO PART REV 2/22/1944; SO ENLGMT 4/7/1944; SO ENLGMT 7/3/1946; PART REV PLO 6148, 2/12/1982; REV PLO 6353, 3/3/1983;		
22																		ALL;					
25	X	X	X	X									X	X	X	X							
27		X	X		X	X	X	X	X	X	X	X		X	X								
34	X	X	X	X	X	X	X	X	X	X	X		X	X	X	X			SO PART REV WDL HASSAYAMPA PROJECT, SO 7/25/1941	2/22/1944	OPEN TO ENTRY; LD TP: 4N 4W;		
3																	9, 10						
14					X	X	X	X	X	X	X	X											
15	X																	LD TP: 5N 4W;	SO ENLGMT WDL HASSAYAMPA PROJECT, SO 7/25/1941	4/7/1944	WITHDRAWN FROM PUBLIC ENTRY UNDER THE FIRST FORM OF WITHDRAWAL; PART REV PLO 6148, 2/12/1982; REV PLO 6353, 3/3/1983;		
14								X	X	X	X						160.00	LEASE / OG	PHX-081359	10/1/1945	CANC 10/1/1950;		
11										X													
12														X	X								
15													X			X							
22	X			X									X			X		LD TP: 5N 3W;	SO ENLGMT WDL HASSAYAMPA PROJECT, SO 7/25/1941	7/3/1946	WITHDRAWN FROM PUBLIC ENTRY UNDER THE FIRST FORM OF WITHDRAWAL; PART REV PLO 6148, 2/12/1982; REV PLO 6353, 3/3/1983;		
14					X	X	X	X									160.00	LEASE / OG	PHX-081360	8/1/1946	CANC 6/23/1950;		
22	X			X																			
23		X						X	X	X	X						280.00	LEASE / OG	PHX-081358	4/1/1947	REL 12/26/1951;		
34	X	X	X	X	X	X	X	X	X	X	X		X	X	X	X	600.00	PATENT / SX	1122022	4/7/1947	9S 6E;		
15													X			X	80.00	LEASE / OG	PHX-081365	5/1/1947	CANC 4/19/1950;		
2	X	X	X	X	X	X	X	X					X	X	X	X		QCD TO US / SX	PHX-081024	9/11/1950	4N 4W;		
14									X	X	X	X					160.00	LEASE / OG	AR-0667	2/1/1951	CANC 1/29/1954;		
22	X			X																			
23		X						X	X								200.00	LEASE / OG	AR-02521	4/1/1952	REL 11/29/1954;		
2	X	X	X	X	X	X	X	X					X	X	X	X		OPENING TO ENTRY	AR-5-7	2/15/1954	6N 1W;		

L NOT INDU LOC

## TOWNSHIP 06 NORTH RANGE 04 WEST OF THE GILA &amp; SALT RIVER MERIDIAN, ARIZONA

SECS	SUBDIVISION																Acres	Kind of Entry or Purpose	Serial Number or Order Number	Action Date	Remarks		
	NE 1/4				NW 1/4				SW 1/4				SE 1/4									Lots	Other Description
	NE	NW	SW	SE	NE	NW	SW	SE	NE	NW	SW	SE	NE	NW	SW	SE							
	For orders affecting disposal or use of unidentified lands withdrawn for classification, minerals, water, and/or other public purposes, and Indian treaties, refer to Index to Miscellaneous Documents																						
15	X																40.00	HE	PHX-070969	12/3/1931	CANC 8/16/1932;		
30		X	X		X			X									160.00	HE	PHX-071259	2/9/1932	REL 8/25/1933;		
30	X			X									X	X			160.00	HE	PHX-071296	2/11/1932	REL 8/25/1933;		
3																	1, 2, 5, 6	160.11	PATENT / CE	1055302	5/17/1932		
23					X	X											80.00	HE	PHX-072051	6/3/1932	CANC 10/5/1934;		
10			X	X			X	X									160.00	HE	PHX-072408	9/21/1932	REL 11/1/1934;		
14								X	X	X	X						160.00	HE	PHX-072532	1/3/1933	CANC 10/19/1940;		
27	X			X									X			X	160.00	PATENT / HE	1064035	5/12/1933			
22	X	X	X	X													160.00	HE	PHX-073480	6/19/1933	CANC 11/3/1939;		
10		X															40.00	PATENT / CE	1067781	1/23/1934			
3																	9	42.11	HE	PHX-075214	6/25/1934	CANC 10/2/1940;	
11											X				X	X							
14	X																160.00	PATENT / HE	1071350	8/8/1934			
15													X			X	80.00	HE	PHX-075370	8/30/1934	CANC 5/9/1940;		
11														X			40.00	PATENT / PS	1072432	9/26/1934			
26		X	X											X	X		160.00	PATENT / HE	1073797	1/9/1935			
13			X	X			X	X									160.00	PATENT / HE	1074340	2/13/1935			
3			X										X				7, 8	159.25	PATENT / HE	1075458	4/22/1935		
11						X	X	X	X								160.00	PATENT / HE	1075754	5/9/1935			
4																	1	40.05	HE	PHX-075240	6/19/1935	CANC 9/7/1938;	
13	X	X			X	X											160.00	PATENT / HE	1077088	8/2/1935			
26					X	X			X	X							160.00	PATENT / HE	1089244	4/1/1937			
15														X			40.00	PATENT / HE	1089546	4/14/1937			
15		X	X	X									X				160.00	PATENT / HE	1097179	5/25/1938			
23					X	X											80.00	PATENT / HE	1100683	1/5/1939			
12								X	X	X	X						160.00	PATENT / HE	1104559	8/23/1939			
10			X	X													80.00	PATENT / HE	1105706	10/18/1939			
22																	ALL;						
23		X					X	X	X	X	X	X											
25																	ALL;						

## TOWNSHIP 06 NORTH RANGE 04 WEST OF THE GILA &amp; SALT RIVER MERIDIAN, ARIZONA

SECS	SUBDIVISION																Acres	Kind of Entry or Purpose	Serial Number or Order Number	Action Date	Remarks		
	NE 1/4				NW 1/4				SW 1/4				SE 1/4									Lots	Other Description
	NE	NW	SW	SE	NE	NW	SW	SE	NE	NW	SW	SE	NE	NW	SW	SE							
For orders affecting disposal or use of unidentified lands withdrawn for classification, minerals, water, and/or other public purposes, and Indian treaties, refer to Index to Miscellaneous Documents																							
27		X	X		X	X	X	X	X	X				X									
28																		ALL;					
29																	2560.00	PERMIT / OG	PHX-054274	3/21/1923	CANC 5/28/1928;		
16	X	X	X	X	X	X	X	X	X	X	X	X					480.00	IL BASE	75	7/7/1923	30N 2W;		
33	X			X									X			X							
34		X	X		X	X	X	X	X	X	X	X		X	X		640.00	SRHE	PHX-055462	12/13/1923	PART REL; CANC 3/19/1929;		
16																		ALL;					
21		X			X	X											775.62	PERMIT / OG	PHX-055199	2/18/1924	CANC 3/18/1940;		
4			X										X	X	X	X	280.64						
9	X			X									X			X	160.00						
16	X			X									X				139.10						
17						X			X	X	X			X			200.00	O WDL PWR PROJECT	AR-306	12/15/1924	O CORR 1/15/1925; O PART VACATED 4/27/1971;		
15						X			X	X	X			X			200.00	O CORRECTION PWR PROJECT, O 12/15/1924	AR-306	1/15/1925	O PART VACATED 4/27/1971;		
16													X	X	X	X	160.00	IL BASE	91	7/7/1926	7N 3E;		
																		ALL SECS 2, 16, 32, 36;	STATE GRANT	ACT OF CONGRESS	1/25/1927	EXTENDS ACT OF 6/20/1910 TO MINERAL LANDS; SUBJECT TO PRIOR RIGHTS;	
34											X						40.00	PATENT / HE	996059	2/18/1927			
10													X	X	X	X	160.00	PATENT / HE	1014542	4/12/1928			
13																		M&B; SUBDIV UNDEF;	R/W TELEPHONE AND TELEGRAPH LINE	PHX-063602	9/26/1928	OTHER TPS: 6N 3W, 7N 1W, 7N 2W, 7N 3W, 8N 1W, 8N 2W; APPVD FOR PD ONLY; EXPIRED 9/26/1978;	
10	X	X	X	X													160.00	HE	PHX-065270	3/11/1929	REL 4/26/1930;		
3													X	X			119.25	HE	PHX-065397	4/27/1929	CANC 8/30/1930;		
27	X			X									X			X	160.00	HE	PHX-069231	12/5/1930	REL 1/7/1931;		
26					X			X	X			X					160.00	HE	PHX-070445	6/22/1931	CANC 7/30/1937;		
22													X			X							
23										X	X						160.00	HE	PHX-070451	6/23/1931	CANC 7/6/1937;		
3														X	X								
10	X																						
11						X											160.00	PATENT / HE	1049157	8/18/1931			
15	X	X	X	X													160.00	HE	PHX-070734	9/26/1931	REL 12/3/1931;		

## TOWNSHIP 06 NORTH RANGE 04 WEST OF THE GILA &amp; SALT RIVER MERIDIAN, ARIZONA

SECS	SUBDIVISION																Acres	Kind of Entry or Purpose	Serial Number or Order Number	Action Date	Remarks		
	NE 1/4				NW 1/4				SW 1/4				SE 1/4									Lots	Other Description
	NE	NW	SW	SE	NE	NW	SW	SE	NE	NW	SW	SE	NE	NW	SW	SE							
	For orders affecting disposal or use of unidentified lands withdrawn for classification, minerals, water, and/or other public purposes, and Indian treaties, refer to Index to Miscellaneous Documents																						
22																							
27																							
34																							
35																							
36																	M&B; SUBDIV UNDEF;	R/W PIPELINE, CANAL AND RESERVOIR	PHX-040052	9/28/1921	OTHER TPS: 5N 3W, 5N 4W; CANC 2/15/1928;		
25																	ALL; 6N 3W;	640.00	PERMIT / OG	PHX-047931	12/23/1921	CANC 10/6/1927;	
33	X			X									X			X							
34		X	X		X	X	X	X	X	X	X	X		X	X			640.00	SRHE	PHX-044968	1/6/1922	REL 6/19/1922;	
3																	ALL;		PERMIT / OG	PHX-050897	1/24/1922	CANC 11/29/1927;	
13									X	X	X	X	X	X	X	X		320.00					
14													X					40.00					
23	X		X	X									X	X	X	X		280.00					
24					X	X	X	X	X	X	X	X	X	X	X	X		480.00					
26	X			X									X			X		160.00	IL	56	4/5/1922	7N 7W;	
10																	ALL;						
11																	ALL;						
14	X	X	X	X	X	X	X	X	X	X	X	X		X	X	X							
15	X	X	X	X	X	X	X	X	X	X	X		X	X	X	X	1, 2	2520.00	PERMIT / OG	PHX-049121	4/15/1922	CANC 10/6/1927;	
33	X			X									X			X							
34		X	X		X	X	X	X	X	X	X	X		X	X			640.00	SRHE	PHX-053941	6/23/1922	REL 6/4/1923;	
30																	ALL;						
31																	ALL;	1280.00	PERMIT / OG	PHX-054205	12/6/1922	CANC 6/25/1928;	
26		X	X		X	X	X	X	X	X	X	X		X	X								
27											X	X			X	X							
33		X	X		X	X	X	X	X	X	X	X		X	X								
34	X			X									X			X							
35																	ALL;	1920.00	PERMIT / OG	PHX-054196	12/20/1922	CANC 7/18/1928;	
21			X	X				X	X	X	X	X	X	X	X	X							
22	X	X	X	X					X	X	X	X	X	X	X	X							

SECS	SUBDIVISION																Acres	Kind of Entry or Purpose	Serial Number or Order Number	Action Date	Remarks		
	NE 1/4				NW 1/4				SW 1/4				SE 1/4									Lots	Other Description
	NE	NW	SW	SE	NE	NW	SW	SE	NE	NW	SW	SE	NE	NW	SW	SE							
	For orders affecting disposal or use of unidentified lands withdrawn for classification, minerals, water, and/or other public purposes, and Indian treaties, refer to Index to Miscellaneous Documents																						
																	ALL SECS 2, 16, 32, 36;		STATE GRANT	ACT OF CONGRESS	6/20/1910	TITLE TO STATE FIXED BY PROC 2/14/1912; SUBJECT TO PRIOR RIGHTS;	
																	ALL SECS 2, 16, 32, 36;		STATE GRANT	ACT OF CONGRESS	6/20/1910	TITLE TO STATE TO FIX ON APPROVAL OF SURVEY; SUBJECT TO PRIOR RIGHTS;	
3								X		X	X							120.00	HE	PHX-019841	11/7/1912	REL 1/19/1915;	
15																							
16																							
21																							
22																	MS 3014;	15.003	PATENT / ME	389347	3/3/1914		
3																							
10																							
11																							
13																							
14																							
24																	M&B; SUBDIV UNDEF;		R/W CONDUIT LINE	PHX-011611	10/26/1914	8N 4W; CANC 6/10/1948;	
22									X														
27	X			X		X	X						X					120.00	HE	PHX-028665	11/17/1916	AMENDED 3/12/1923; CANC 2/12/1930;	
22					X	X	X	X										160.00	HE	PHX-035625	7/6/1917	CANC 2/15/1923;	
2																	M&B;						
3																	M&B;						
11																	M&B;						
12																	M&B;						
13																	M&B;						
24																	M&B; SUBDIV UNDEF;		R/W TELEPHONE AND TELEGRAPH LINE	PHX-040609	6/3/1919	3N 1E; APPVD FOR PD ONLY; EXPIRED 6/2/1969;	
1																							
12																	6N 3W;		PERMIT / OG	PHX-047675	10/19/1920	CANC 3/20/1928;	
13	X	X	X	X	X	X	X	X	X														
23		X			X	X	X	X	X	X	X	X						680.00	PERMIT / OG	PHX-050361	8/8/1921	CANC 7/13/1928;	
10																							
15																							



## TOWNSHIP 06 NORTH RANGE 04 WEST OF THE GILA &amp; SALT RIVER MERIDIAN, ARIZONA

SECS	SUBDIVISION																Acres	Kind of Entry or Purpose	Serial Number or Order Number	Action Date	Remarks		
	NE 1/4				NW 1/4				SW 1/4				SE 1/4									Lots	Other Description
	NE	NW	SW	SE	NE	NW	SW	SE	NE	NW	SW	SE	NE	NW	SW	SE							
	For orders affecting disposal or use of unidentified lands withdrawn for classification, minerals, water, and/or other public purposes, and Indian treaties, refer to Index to Miscellaneous Documents																						
																	ALL SECS 16 AND 36;	TERRITORIAL RESERVATION	ACT OF CONGRESS	2/24/1863	EXTENDS AND CONTINUES IN FORCE ACTS OF 9/9/1850 AND 7/22/1854;		
3										X													
4	X			X									X				160.00	PATENT / CE	167	11/20/1882			
3																							
4																							
10																	M&B; SUBDIV UNDEF;	R/W RR	PHX-086554	7/31/1893	PERPETUAL; 7N 5W;		
21															X								
28	X																80.00	DLE	P-101	5/18/1896	REL 3/22/1899;		
22											X	X											
27						X	X										160.00	HE	P-1277	5/18/1896	REL 3/22/1899;		
24																	M&B; SUBDIV UNDEF;	R/W RR	PHX-086571	1/11/1897	PERPETUAL; 14N 1W;		
24																	M&B; SUBDIV UNDEF;	R/W STATION GROUNDS	PHX-086576	6/4/1897	PERPETUAL;		
21															X								
28	X																80.00	DLE	P-118	3/22/1899	CANC 10/26/1908;		
22											X	X											
27						X	X										160.00	HE	P-1581	3/22/1899	CANC 3/13/1907;		
24					X	X	X	X									160.00	HE	P-1595	7/22/1899	REL 6/25/1900;		
24	X	X	X	X													160.00	PATENT / CE	624	1/27/1900			
24					X	X	X	X									160.00	HE	P-1624	6/25/1900	REL 6/24/1904;		
24					X	X	X	X									160.00	HE	P-1838	6/24/1904	REL 5/25/1906;		
15																							
16																							
21																							
22																	LOT 2060 (MS);	52.557 PATENT / ME	43785	5/10/1906	MC 54;		
24					X	X	X	X									160.00	HE	PHX-03441	5/25/1906	REL 6/7/1909;		
24					X												40.00	HE	PHX-06218	6/7/1909	CANC 1/27/1912;		
7																							
8																							
17																							
18																	MS 2547;	PATENT / ME	95588	12/13/1909			

## TOWNSHIP 06 NORTH RANGE 04 WEST OF THE GILA &amp; SALT RIVER MERIDIAN, ARIZONA

SECS	SUBDIVISION																Acres	Kind of Entry or Purpose	Serial Number or Order Number	Action Date	Remarks		
	NE 1/4				NW 1/4				SW 1/4				SE 1/4									Lots	Other Description
	NE	NW	SW	SE	NE	NW	SW	SE	NE	NW	SW	SE	NE	NW	SW	SE							
For orders affecting disposal or use of unidentified lands withdrawn for classification, minerals, water, and/or other public purposes, and Indian treaties, refer to Index to Miscellaneous Documents																							
14																		SESWSW, S2SESW;	30.00	SLUP	AR-015182	2/13/1958	EXPIRED 2/13/1963;
22																		E2E2NENE;	10.00	SLUP	AR-015183	2/13/1958	EXPIRED 2/13/1963;
21			X	X	X	X	X	X	X	X	X	X	X	X	X	X			560.00	IL	247	6/30/1958	1N 1W;
31																		ALL;					
33																		ALL;		PATENT / PX	1198463	8/20/1959	4N 4W;
25	X	X																	80.00	IL	262	10/6/1959	OTHER TPS: 1N 1W, 1N 5W, 2N 10W, 3N 10W, 3N 12W, 4N 3W, 4N 15W, 5N 14W, 10N 4W, 23N 17W, 25N 13W, 27N 7W, 27N 14W, 28N 22W, 31N 17W, 31N 22W, 33N 4W, 35N 4W, 1S 32E, 3S 16E, 4S 7E, 4S 27E, 4S 32E, 7S 3E, 7S 16E, 11S 8E, 13S 14E, 15S 5 1/2E, 15S 11E, 17S 15E, 18S 3E, 18S 4E, 19S 7E, 21S 3 1/2E, 2N 5E, 3N 24E, 3N 32E, 4 1/2N 18E, 4 1/2N 21E, 5N 1E, 5N 16E, 6N 26 1/2E, 9N 14E, 11N 31E, 13N 21E, 13N 22E, 18N 17E, 18N 27E, 20N 8E, 20N 14E, 21N 22E, 23N 11E, 23N 18E, 23N 22E, 23N 28E, 24N 18E, 24N 27E, 25N 11E, 25N 23E, 26N 10E, 26N 15E, 26N 20E, 26N 24E, 28N 16E, 29N 12 1/2E, 29N 14E, 30N 12 1/2E, 33N 8 1/2E, 33 1/2N 12 1/2E, 34N 6E, 35N 7E, 37N 5E, 38N 8E, 41N 9E, 42N 15E, 42N 17E, 1S 11W, 3S 10W, 3S 11W, 6S 22W, 8S 10W, 8S 22W, 12S 20W, 13S 18W, 16S 10W, 17S 5W;
7																X				RAINWATER CATCHMENT		9/26/1960	
22	X			X																			
23						X	X	X			X												
26					X															R/W TRANSMISSION LINE	AR-028481	11/2/1960	PREPERMIT; AMENDED 11/18/1960; APPVD 2/10/1961; TO TERM 2/10/2011;
15																		SWSESE;		R/W TRANSMISSION LINE	AR-028481	2/10/1961	PREPERMIT; TO TERM 2/10/2011; PART REL 8/20/1970; CASE CLOSED 8/30/2013; REF AZA-36317, 8/30/2013;
23																		NWSWNW;		R/W TRANSMISSION LINE	AR-030457	5/18/1961	TO TERM 5/17/2011; PREPERMIT 4/12/1961; CASE CLOSED 5/17/2011; REF AZA-036320, 8/30/2013;
14																		NWSWSESE, NWSESE, S2NESESE, NESESESE;		FLUP	AR-032074	11/13/1962	EXPIRED 12/1/1967; EXT 12/1/1972; EXPIRED 12/1/1972;
3																	9	7N 4W;		R/W HIGHWAY	AR-032173	5/6/1963	PERPETUAL;
2																		E2SWSWNW, SESWNW;		FLUP #249	AR-032287	6/25/1963	TO EXPIRE 7/1/1968; EXT; EXPIRED 6/30/1973;
14																		NENESENE;		R/W HIGHWAY	AR-033100	2/24/1964	PERPETUAL;
14																		S2SESESW;					
22																		N2SENENE;		SLUP	AR-032209	7/2/1964	TO EXPIRE 7/1/1969; EXT; TO EXPIRE 7/1/1974; EXT; EXPIRED 7/1/1979;
14		X	X										X	X					160.00	IL	317	8/14/1964	5S 4W;
22	X			X																			
23						X	X													R/W TELEPHONE AND TELEGRAPH LINE	AR-034383	3/15/1965	TO TERM 2/16/2015; EFF 2/17/1965;
10					X	X	X	X	X	X	X	X								IL	336	2/1/1966	30 1/2N 16W;

## TOWNSHIP 06 NORTH RANGE 04 WEST OF THE GILA &amp; SALT RIVER MERIDIAN, ARIZONA

SECS	SUBDIVISION																Acres	Kind of Entry or Purpose	Serial Number or Order Number	Action Date	Remarks		
	NE 1/4				NW 1/4				SW 1/4				SE 1/4									Lots	Other Description
	NE	NW	SW	SE	NE	NW	SW	SE	NE	NW	SW	SE	NE	NW	SW	SE							
	For orders affecting disposal or use of unidentified lands withdrawn for dassification, minerals, water, and/or other public purposes, and Indian treaties, refer to Index to Miscellaneous Documents																						
1																	ALL;						
2																	ALL;						
3																	ALL;						
4																	ALL;						
5																	ALL;						
6																	ALL;						
7																	ALL;						
8																	ALL;						
9																	ALL;						
10																	ALL;						
11																	ALL;						
12																	ALL;						
13																	ALL;						
14																	ALL;						
15																	ALL;						
16																	ALL;						
17																	ALL;						
18																	ALL;						
19																	ALL;						
20																	ALL;						
21																	ALL;						
22																	ALL;						
23																	ALL;						
24																	ALL;						
25																	ALL;						
26																	ALL;						
27																	ALL;						
28																	ALL;						
29																	ALL;						

## TOWNSHIP 06 NORTH RANGE 04 WEST OF THE GILA &amp; SALT RIVER MERIDIAN, ARIZONA

SECS	SUBDIVISION																Acres	Kind of Entry or Purpose	Serial Number or Order Number	Action Date	Remarks		
	NE 1/4				NW 1/4				SW 1/4				SE 1/4									Lots	Other Description
	NE	NW	SW	SE	NE	NW	SW	SE	NE	NW	SW	SE	NE	NW	SW	SE							
For orders affecting disposal or use of unidentified lands withdrawn for classification, minerals, water, and/or other public purposes, and Indian treaties, refer to Index to Miscellaneous Documents																							
30																		ALL; 1N 4W;		A-1100	7/21/1967	SEGREGATES THE PUBLIC LANDS FROM APPROPRIATION UNDER AGRICULTURAL LAND LAWS, PS, SX; PUB IN FR 7/27/1967; O CL 10/17/1967; PUB IN FR 10/23/1967;	
1			X	X			X	X	X	X	X	X					1-4	491.64	IL	399	10/2/1967	OTHER TPS: 1N 12E, 2N 12E, 2N 15E, 2N 28E, 3N 15E, 3N 15 1/2E, 3N 18E, 4N 17E, 8N 28E, 9N 27E, 10N 26E, 10N 28E, 11N 26E, 11N 27E, 11N 28E, 13N 8E, 28N 13E, 3S 24W, 4S 24W, 6S 8W, 18S 4W, 1S 26E, 2S 5E, 3S 4E, 4S 22E, 5S 5E, 5S 19E, 21S 19E, 8N 5W, 16N 2W, 36N 4W,	
15					X	X	X		X									160.00	IL	514	4/13/1971	(AR-016951);	
4			X										X	X	X	X	2, 3						
9	X			X									X			X							
15			X						X						X		1, 2						
16	X			X									X				2		O PART VACATED PWR PROJECT 306, O 12/15/1924	A-6225	4/27/1971	FPC;	
4			X										X	X	X	X	2, 3						
9	X			X									X			X							
15			X						X						X		1, 2						
16	X			X									X				2		O OPENING TO ENTRY	A-6225	9/20/1971	9N 3W;	
2			X																				
11		X	X	X	X								X				7N 4W;		R/W TELEPHONE AND TELEGRAPH LINE	A-4441	12/30/1971	TO TERM 12/29/2021; PART REL;	
27		X	X		X	X	X	X	X	X	X	X		X	X			480.00	IL	521	1/19/1972	(AR-016954); OTHER TPS: 25N 13W, 26N 14W, 6S 5W, 8S 11W, 8N 14E, 9N 4E, 14N 7E;	
2																	S2NESWNW, SESENWSWNW, NWSESWNW, SWSWNW;		FUP #5608-C	A-8045	9/11/1974	EXPIRED 9/10/1979;	
11										X									R/W ELECTRIC DISTRIBUTION LINE	A-8931	4/14/1975	TO TERM 4/13/2025;	
11																	S2SWSW;		R/W TELEPHONE LINE	A-10227	7/12/1978	TO TERM 7/11/2008;	
29																	ALL;						
30	X	X	X	X	X			X	X			X	X	X	X	X	1-4						
31	X	X	X	X	X			X	X			X	X	X	X	X	1-4						
33						X											5N 4W;	1953.32	LEASE / OG	A-12782	2/21/1980	EFF 3/1/1980; TERM 3/1/1987; OG SIM; CASE CLOSED 4/1/1987;	
23		X					X	X	X	X	X	X											
25			X	X	X	X	X	X	X	X	X	X	X	X	X	X							
26					X			X	X									960.00	LEASE / OG	A-12779	7/8/1980	EFF 8/1/1980; TERM 8/1/1986; OG SIM FEB 1987; CASE CLOSED 4/19/1991;	

## TOWNSHIP 06 NORTH RANGE 04 WEST OF THE GILA &amp; SALT RIVER MERIDIAN, ARIZONA

SECS	SUBDIVISION																Acres	Kind of Entry or Purpose	Serial Number or Order Number	Action Date	Remarks		
	NE 1/4				NW 1/4				SW 1/4				SE 1/4									Lots	Other Description
	NE	NW	SW	SE	NE	NW	SW	SE	NE	NW	SW	SE	NE	NW	SW	SE							
For orders affecting disposal or use of unidentified lands withdrawn for classification, minerals, water, and/or other public purposes, and Indian treaties, refer to Index to Miscellaneous Documents																							
26													X										
28																		ALL;					
33	X	X	X	X	X			X	X	X	X	X	X	X	X	X	X						
34																		ALL;					
35																		ALL;	2560.00	LEASE / OG	A-12780	7/8/1980	EFF 8/1/1980; TERM 8/1/1986; OG SIM FEB 1987; CASE CLOSED 4/19/1987
19	X	X	X	X	X			X	X			X	X	X	X	X	1-4						
20																		ALL;					
21		X															1						
22	X	X	X	X			X	X	X	X	X	X	X	X	X	X	1, 2	1971.09	LEASE / OG	A-12781	7/8/1980	EFF 8/1/1980; TERM 8/1/1986; OG SIM FEB 1987; CASE CLOSED 4/1/1987;	
8	X	X	X	X	X	X	X	X	X				X	X	X	X	1-3	LESS MS 2547;					
9																		ALL;					
16	X	X	X	X	X	X	X	X	X	X	X	X	X	X			1, 2	LESS ME PATENT;					
17	X	X	X	X			X	X	X	X	X	X	X	X	X	X	1, 2	LESS ME PATENT;					
18	X	X	X	X	X			X	X			X	X	X	X	X	1-4		3139.24	LEASE / OG	A-14095	3/25/1981	EFF 4/1/1981; TERM 4/1/1984; OG SIM FEB 1985; CASE CLOSED 5/1/1985;
10													X	X	X	X							
12	X	X	X	X	X	X	X	X					X			X							
14		X	X	X										X	X	X		800.00	LEASE / OG	A-14954	3/25/1981	EFF 4/1/1981; TERM 4/1/1985; OG SIM AUG 1985; CASE CLOSED 11/1/1985;	
26												X							R/W ELECTRIC DISTRIBUTION LINE	A-13531	4/9/1981	TO TERM 4/9/2001; CASE CLOSED 6/7/2001;	
11											X						0.01	R/W RIP-RAP STRUCTURE	A-16575	5/14/1981	TO TERM 5/13/2011; RENEWED 8/23/2013; TO TERM 12/31/2040;		
11	X	X	X	X	X								X										
12					X	X	X	X					X			X		480.00	APLN / IL	A-17000-C	8/27/1981	SEGREGATED FROM THE PUBLIC LAND LAWS, INCLUDING THE MINING LAWS, BUT NOT THE MINERAL LEASING LAWS;	
12														X	X								
23								X	X			X											
25			X	X	X	X	X	X	X	X	X	X	X	X	X	X							
26					X			X	X			X											
35																		ALL;	1560.00	APLN / IL	A-17000-D	8/27/1981	SEGREGATED FROM THE PUBLIC LAND LAWS, INCLUDING THE MINING LAWS, BUT NOT THE MINERAL LEASING LAWS; REV PLO 6148, 2/12/1982;
11													X					40.00					
12					X	X	X	X					X			X		240.00	IL	553	9/14/1981	(A-17000-C); OTHER TPS: 7N 4W, 7N 5W, 8N 4W, 8N 5W;	



## TOWNSHIP 06 NORTH RANGE 04 WEST OF THE GILA &amp; SALT RIVER MERIDIAN, ARIZONA

SECS	SUBDIVISION																Acres	Kind of Entry or Purpose	Serial Number or Order Number	Action Date	Remarks		
	NE 1/4				NW 1/4				SW 1/4				SE 1/4									Lots	Other Description
	NE	NW	SW	SE	NE	NW	SW	SE	NE	NW	SW	SE	NE	NW	SW	SE							
For orders affecting disposal or use of unidentified lands withdrawn for classification, minerals, water, and/or other public purposes, and Indian treaties, refer to Index to Miscellaneous Documents																							
2																		S2NESWNW, SESENWSWNW, NWSSEWNW, SWSWNW;		FUP MS 5608	A-12557	1/4/1982	EFF 1/4/1982; EXPIRED 12/1/1986;
35																		N2N2NW;	1.10	R/W ROAD	A-16818	1/29/1982	TO TERM 1/28/2012;
22																X							
23									X	X	X	X								R/W ROAD	A-16817	2/11/1982	TO TERM 2/10/2012; RENEWED 2/26/2014; EFF 2/10/2012; TO TERM 12/31/2041;
12														X	X								
23								X	X			X											
25					X	X	X	X	X	X	X	X	X										
26					X			X	X			X											
35																		ALL;		PLO PART REV WDL HASSAYAMPA PROJECT, SO 7/25/1941, SO 4/7/1944, AND SO 7/3/1946	6148	2/12/1982	(A-12828); LD TP: 4N 3W;
12														X	X								
23								X	X			X											
25			X	X	X	X	X	X	X	X	X	X	X	X	X	X	X						
26					X			X	X			X											
35																		ALL;	1580.00	IL	557	2/12/1982	4N 3W;
15	X													X			X			R/W ROAD	A-16819	4/20/1982	TO TERM 4/19/2012; CANC AND CASE CLOSED 6/1/1994;
11	X	X	X	X	X													3S 1E;	200.00	IL	571	9/30/1982	(A-17000-C);
3																	9, 10						
11												X											
14					X	X	X	X	X	X	X	X	X										
15	X													X			X						
22	X			X										X			X						
23		X					X			X	X							LD TP: 5N 3W;		PLO REV WDL HASSAYAMPA PROJECT, SO 7/25/1941, SO 4/7/1944, AND SO 7/3/1946	6353	3/3/1983	(A-12828); O OPENING TO ENTRY 4/13/1983;
15																		NWSESE;		R/W WATER STORAGE TANK	A-18548	7/7/1983	TO TERM 7/6/2013; CANC AND CASE CLOSED 7/5/1995;
14																		S2SWSSEW;					
22																		E2NENE;	5.75	R/W RUNWAY EXTENSION	A-17409	9/29/1983	TO TERM 9/28/2013; REL 1/20/2011; CASE CLOSED 3/25/2011;
33																		WEST 1100 FT OF E2;		PATENT / CMI	02-87-0040	8/26/1987	(A-21777);

## TOWNSHIP 06 NORTH RANGE 04 WEST OF THE GILA &amp; SALT RIVER MERIDIAN, ARIZONA

SECS	SUBDIVISION																Acres	Kind of Entry or Purpose	Serial Number or Order Number	Action Date	Remarks		
	NE 1/4				NW 1/4				SW 1/4				SE 1/4									Lots	Other Description
	NE	NW	SW	SE	NE	NW	SW	SE	NE	NW	SW	SE	NE	NW	SW	SE							
For orders affecting disposal or use of unidentified lands withdrawn for classification, minerals, water, and/or other public purposes, and Indian treaties, refer to Index to Miscellaneous Documents																							
33																		E2 EXCEPT WEST 1100 FT THEREOF;	NORA / CMI	AZA-25276	8/12/1991	SEGREGATES THE MINERAL INTERESTS FROM APPROPRIATION UNDER THE PUBLIC LAND LAWS, INCLUDING THE MINING LAWS, SEG TO TERM 8/11/1993; APLN WDN AND CASE CLOSED 7/23/1993; LD TP: 4N 4W;	
15																		N2NWNESE;	0.12 R/W UNDERGROUND POWER CABLE	AZA-25354	11/21/1991	TO TERM 11/20/2016;	
15	X												X			X							
22	X	X	X	X																			
23																		N2SWNW;	23.30 R/W ROAD	AZA-26530	6/23/1992	PERPETUAL;	
33																		E2 EXCEPT WEST 1100 FT THEREOF;	NORA / CMI	AZA-28010	8/6/1993	SEGREGATES THE MINERAL INTERESTS FROM APPROPRIATION UNDER THE PUBLIC LAND LAWS, INCLUDING THE MINERAL LAWS; SEG TO TERM 7/23/1995; LD TP: 4N 4W;	
3																	9						
4																	1						
11											X												
14				X	X	X		X											R/W FIBER OPTIC CABLE	AZA-27844	1/20/1994	TO TERM 1/19/2024; OTHER TPS: 6N 12W, 7N 4W, 7N 12W, 7N 13W, 8N 13W, 9N 13W, 9N 14W, 10N 14W, 11N 15W, 12N 15W, 13N 15W, 13N 18W, 14N 16W, 14N 17W, 15N 17W, 15N 18W, 16N 18W, 16 1/2N 18W, 17N 18W, 18N 18W, 19N 17W, 20N 17W, 21N 18W, 21N 19W, 21N 20W, 22N 18W, 23N 18W, 23N 19W, 24N 19W, 25N 19W, 25N 20W, 26N 20W, 27N 21W, 28N 21W; AMENDED 4/15/1999; THIS TP REL;	
33																		SE EXCEPT WEST 1100 FT THEREOF;	PATENT / CMI	02-95-0033	7/11/1995	{AZA-28010}; LD TP: 5N 4W;	
33																		NE EXCEPT WEST 1100 FT THEREOF;	APLN / CMI	AZA-29195	7/28/1995	SEGREGATES THE MINERAL INTERESTS FROM THE MINING LAWS AND MINERAL LEASING LAWS; SEG TO TERM 7/27/1997; LD TP: 3N 5W;	
33																		NE EXCEPT WEST 1100 FT;	PATENT / CMI	02-97-0010	7/11/1997	{AZA-29195}; OTHER TP: 3N 5W;	
14																	1		NORA / SALE	AZA-29339	12/31/1998	SEGREGATES THE LAND FROM APPROPRIATION UNDER THE PUBLIC LAND LAWS, INCLUDING THE MINING LAWS; SEG TO TERM 9/30/1999	
14																	1		PATENT / SALE	02-99-0018	5/4/1999	{AZA-29339};	
15																		SWSSESE;					
22	X			X																			
23																	1.463	R/W TRANSMISSION LINE	AZA-36317	8/30/2013	TO TERM 12/31/2040; EFF 2/11/2011;		
23																	0.03	NWSWNW;	R/W TRANSMISSION LINE	AZA-36320	8/30/2013	TO TERM 12/31/2040; EFF 5/18/2011;	

RUN TIME: 10:56 AM

DEPARTMENT OF INTERIOR  
BUREAU OF LAND MANAGEMENT

RUN DATE: 03/22/2018  
Page 1 of 1

Input Parameters for Geographic Report with Land

System Id = CR

Admin State = AZ

Geo State =

Casetype Begins With

Case Disp Txt = AUTHORIZED, CANCELLED, EXPIRED, PENDING, REJECTED, VOID, WITHDRAWN

Mer Twp Rng =

Section =

Mtrs = 14 0060N 0040W 002, 14 0060N 0040W 999, 14 0070N 0040W 035, 14 0070N 0040W 999

Commodity =

Commodity Txt =

Pending Org =

Pend Org Decode =

Total Rows Returned: 4

NO WARRANTY IS MADE BY BLM FOR USE OF THE DATA  
FOR PURPOSES NOT INTENDED BY BLM

RUN TIME: 10:56 AM

Adm State: AZ

UNITED STATES DEPARTMENT OF INTERIOR  
BUREAU OF LAND MANAGEMENT  
GEOGRAPHIC REPORT WITH LAND  
Sorted by Serial Number

RUN DATE: 03/22/2018  
Page 1 of 1

Serial Number: AZA 004441  
Total Case Acres: 1.450

<u>Casetype</u>	<u>Case Disp</u>	<u>14</u>	<u>0060N</u>	<u>0040W</u>	<u>Sect</u>	<u>Sur Typ</u>	<u>Sur Num</u>	<u>Suff</u>	<u>Subdivision</u>	<u>Act Pend</u>
285002	AUTHORIZED				002	ALIQ			SWNW;	

Serial Number: AZA 031568  
Total Case Acres: 1.000

<u>Casetype</u>	<u>Case Disp</u>	<u>14</u>	<u>0060N</u>	<u>0040W</u>	<u>Sect</u>	<u>Sur Typ</u>	<u>Sur Num</u>	<u>Suff</u>	<u>Subdivision</u>	<u>Act Pend</u>
293200	EXPIRED				002	FF			PORTION OF;	

Serial Number: AZA 035151  
Total Case Acres: 1.000

<u>Casetype</u>	<u>Case Disp</u>	<u>14</u>	<u>0060N</u>	<u>0040W</u>	<u>Sect</u>	<u>Sur Typ</u>	<u>Sur Num</u>	<u>Suff</u>	<u>Subdivision</u>	<u>Act Pend</u>
293200	PENDING				002	FF			PORTION OF;	

Serial Number: AZA 035151  
Total Case Acres: 1.000

<u>Casetype</u>	<u>Case Disp</u>	<u>14</u>	<u>0070N</u>	<u>0040W</u>	<u>Sect</u>	<u>Sur Typ</u>	<u>Sur Num</u>	<u>Suff</u>	<u>Subdivision</u>	<u>Act Pend</u>
293200	PENDING				035	FF			PORTION OF;	

## MARICOPA/YAVAPAI COUNTY

MARICOPA  
013

YAVAPAI  
025

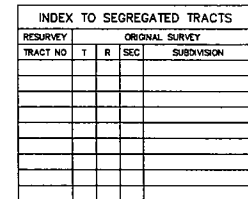

**WARNING STATEMENT**  
This plot is the Bureau's Record of Title, and should be used only as a graphic display of the township's survey data. Records hereon do not reflect title changes which may have been effected by lateral movements of rivers or other bodies of water. Refer to the cadastral surveys for official survey information.

CURRENT TO	88	
2-20-2003	PV	T 7 N
		R 4 W

T	7 N
R	4 W



[illegible][illegible]

AZA 036320 R/W Transmission Line 20'  
Sec 23: NW1/4SW1/4NW1/4

SCALE in chains

This plot is the Bureau's Record of Title, and should be used only as a graphic display of the township survey data. Records hereon do not reflect title changes which may have been effected by lateral movements of rivers or other bodies of water. Refer to the cadastral surveys for official survey information.

CURRENT TO	NW	GSR Mer
7-28-2014	ACAD	T 6 N
		R 4 W